

**AMENDMENT**

**TO THE**

**OCEAN COUNTY DISTRICT SOLID WASTE MANAGEMENT PLAN**

**April 3, 1996**



**Prepared by:**

**Ocean County Department of Solid Waste Management**  
**129 Hooper Avenue**  
**Toms River, New Jersey**

ALAN W. AVERY, JR.  
DIRECTOR

ERNEST J. KUHLEIN, JR., P.E.  
ASSISTANT DIRECTOR

JOHN C. SAHRADNIK  
COUNSEL

JOHN HAAS  
DISTRICT RECYCLING COORDINATOR



**OCEAN COUNTY  
DEPARTMENT OF SOLID WASTE MANAGEMENT**

129 Hooper Avenue  
P.O. Box 2191  
Toms River, New Jersey 08754-2191  
Telephone (908) 506-5047  
FAX (908) 244-8396

JAMES F. LACEY  
FREEHOLDER - LIAISON

SOLID WASTE ADVISORY COUNCIL

THOMAS CERVASIO, CHAIRMAN  
HERBERT CLOSE, VICE CHAIRMAN

April 4, 1996

Commissioner Robert C. Shinn, Jr.  
Department of Environmental Protection  
CN 402  
401 East State Street, Floor 7  
Trenton, New Jersey 08625-0402

Dear Commissioner Shinn:

On behalf of the Ocean County Board of Chosen Freeholders, I am enclosing the adopted Resolution and Amendment to the Ocean County District Solid Waste Management Plan. This Plan Amendment responds to the Department's Certification of January 14, 1993. Additional copies of the Amendment, with the Hearing Record, will be forwarded to the Department at a later date.

To summarize, the Amendment mandates the recycling of additional materials for the residential and non-residential sectors of the County. It clarifies the description of the proposed source separated compost facility at the Ocean County Landfill. The Amendment also addresses regionalization of our Recyclable Materials Processing Facility and public education and awareness programs to increase our source reduction efforts. Other provisions include solid waste and recycling facilities added or deleted from the District Plan, medical waste management procedures and the disbursement of Ocean County's Resource Recovery Investment Tax Funds.

The Board appreciates your review. If you or your staff has any questions concerning the Amendment, please do not hesitate to contact me.

Very truly yours,

Alan W. Avery, Jr.  
Director

AWA:ka

Enclosures

c: Guy Watson, Bureau Chief, Division of Solid Waste Management  
John C. Sahradnik, County Counsel

Recycled Paper



SPECIAL ASSISTANCE/ACCOMMODATIONS available, please call (908) 506-5047 (V).

### OCEAN COUNTY BOARD OF CHOSEN FREEHOLDERS

Joseph H. Vicari.....	Freeholder Director
James F. Lacey.....	Deputy Director
John C. Bartlett, Jr.,.....	Freeholder
John P. Kelly.....	Freeholder
James J. Mancini.....	Freeholder
Steven L. Pollock.....	County Administrator
Daniel J. Hennessy.....	Clerk of the Board
Franklin H. Berry, Jr., Esq. ....	County Counsel

### OCEAN COUNTY SOLID WASTE ADVISORY COUNCIL

Thomas Cervasio.....	Chairman
Theresa Lettman.....	Vice Chairperson
James Boekholt.....	Ocean County Mayors' Assoc. Representative
Jean Burnett.....	Citizen Member
Alvin Burdge.....	Lakewood Township Representative
Daniel J. Caraccio.....	Industry Representative
Herbert Close.....	Citizen Member
David E. Ekermann.....	Ocean Township Representative
Benjamin Epstein.....	Citizen Member
Lauren Fischbach.....	Citizen Member
Charles Hesse.....	Industry Representative
Henry J. Krywinski.....	Citizen Member
Salvatore Minneci.....	Citizen Member
Pasquale A. Musto.....	Citizen Member
Suzanne Plesnarski.....	Citizen Member
Lorraine Sansone.....	Citizen Member
Pearl Schwartz.....	Citizen Member
Isabel Sherwood.....	Citizen Member
Alan W. Avery, Jr. ....	Ex-Officio Member
Robert Holland.....	Ex-Officio Member
Robert Ingenito.....	Ex-Officio Member
John C. Bartlett, Jr. ....	Freeholder Liaison
James F. Lacey.....	Freeholder Liaison

### OCEAN COUNTY DEPARTMENT OF SOLID WASTE MANAGEMENT

Alan W. Avery, Jr. ....	Director
Ernest J. Kuhlwein, Jr., P.E. ....	Assistant Director
Arthur Burns.....	Superintendent, Recycling Operations
John Haas.....	District Recycling Coordinator
Kathleen Avery.....	Assistant District Recycling Coordinator
Charles Ruoff.....	Management Specialist
Joseph Carter.....	Supervisor, O.C. Southern Recycling Center
Joseph Hummel.....	Supervisor, O.C. Northern Recycling Center
Joseph Johnson.....	Supervisor, Composting Operations
Gail A. Coppola.....	Principal Clerk Stenographer
Robin Cunningham.....	Administrative Clerk
Debra Herbert.....	Principal Clerk Typist
Dawn Krieger.....	Senior Clerk Typist

## TABLE OF CONTENTS

	<u>Page</u>
1. INTRODUCTION	1
2. RECYCLING	3
2.1 Newly Mandated Materials	3
2.2 Dry Cell Batteries	5
2.3 Vegetative Waste Management	6
2.4 Recycling Estimates and Projections	8
3. SOURCE REDUCTION	11
3.1 Public Education Program	11
3.2 Per Container Rate	16
3.3 Procurement Policy	17
3.4 Waste Audits	18
3.5 Grass Clippings	19
3.6 Household Hazardous Waste	22
4. PLAN APPROVED FACILITIES	26
4.1 Dover Township Public Works Facility	26
4.2 Lacey Compost	27
4.3 Tuckerton Sand & Gravel Landfill	27
4.4 Ocean County Landfill Corporation Landfill	27
4.5 Ocean Gate Transfer Station	28
4.6 Toms River Veterinary Hospital	28
4.7 Ocean County Utilities Authority	28
5. OCEAN COUNTY LANDFILL CORPORATION COMPOST FACILITY	29
6. RESOURCE RECOVERY INVESTMENT TAX FUND	32
7. REGIONALIZATION	33
8. MEDICAL WASTE	34

## **TABLES**

		<b><u>Page</u></b>
<b>Table 1</b>	- Final - Percentage of Total Material Recycled for 1994, in Tons, by Municipality	9
<b>Table 2</b>	- Waste Materials Received at the Ocean County Landfill in 1994 by Waste Type and Municipality of Origin	31
<b>Table 3</b>	- Ocean County - 1993 AGR Data - Preliminary Data - Hospitals	35
<b>Table 4</b>	- Ocean County - 1993 AGR Data - Preliminary Data - Number of Generators, by SIC Code	36-37

## **FIGURES**

<b>Figure A</b>	- Percentage of Total Materials Recycled in Ocean County by Municipality, Final - 1994	10
<b>Figure B</b>	- Earth Machine Survey	21
<b>Figure C</b>	- Ocean County Household Hazardous Waste Collection Program - Quantities and Costs	25

## **APPENDICES**

- Appendix I.** List of Approved Solid Waste & Recycling Facilities
- Appendix II.** Dover Township Public Works Facility Location Map
- Appendix III.** Dover Township Public Works Facility Agreement
- Appendix IV.** Response Document
- Appendix V.** Resolution of Adoption - Solid Waste Advisory Council
- Appendix VI.** Resolution of Adoption - Board of Chosen Freeholders

**Section 1**  
**INTRODUCTION**

This document is a proposed amendment to the Ocean County District Solid Waste Management Plan. The Solid Waste Management Act (N.J.S.A. 13:E-1 et seq.) requires that each county adopt such a plan and that it be amended periodically and as otherwise required by changing circumstances.

The original Plan was adopted by the Board of Chosen Freeholders on July 18, 1979 and has since been amended seven times. This current proposal responds to comments made by the Commissioner of the Department of Environmental Protection and Energy in his January 14, 1993 Certification of the Amendment adopted by the Board on August 4, 1992; and it makes other changes as well.

The specific purposes of this proposed amendment are to:

- \* Revise the description of the proposed Ocean County Landfill compost operation.
- \* Address facilities to be included or deleted from the District Solid Waste Management Plan.
- \* Identify and describe expansions and other changes in the County's recycling program including the management of dry cell batteries, mandating of additional recyclables, vegetative composting and recycling projections.
- \* Provide a description of the County's current source reduction activities including public education, consideration of disposal charges per container of waste, procurement policy, waste audits of large enterprises, reduction of grass clippings and management of household hazardous waste.
- \* Revise a plan addressing the disbursement of Ocean County's Resource Recovery Investment Tax Fund.

- \* Discuss regionalization activities.
- \* Describe medical waste management.
- \* Provide an updated listing of Plan approved solid waste and recycling facilities (Appendix I).



## **Section 2**

### **RECYCLING**

#### **2.1 Newly Mandated Materials**

The policy of the County is to encourage recycling to the maximum extent possible based upon the availability of markets and facilities to process recyclable materials. There has been a significant increase in the number of private recycling facilities in Ocean County during the past decade as a result of the County's policy and they have the ability to recycle a wide range of materials. In addition, recycling markets have expanded within our region and there are a sufficient number of markets available for all the new mandatory recyclable materials. Therefore, the County will designate the following as mandatory recyclable materials effective, January 1, 1997. This means that these materials may not be disposed of at the Ocean County Landfill as solid waste and that it is the County's desire to facilitate the recycling of a greater portion of the waste stream which is generated in Ocean County. A significant portion of the newly designated mandatory materials are currently being recycled in both the residential sector and in the commercial, industrial and institutional sector.

#### **\* Residential Sector:**

- a) mixed paper - magazines, catalogs, junk mail and used writing paper
- b) automobile batteries
- c) motor oil
- d) white goods
- e) tires

#### **\* Commercial, Industrial & Institutional Sectors:**

- a) stumps, tree trunks and brush. Existing stump handling facilities are grandfathered - Ocean County Landfill and Tanner Landfill.
- b) concrete
- c) cement blocks

- d) bricks
- e) asphalt
- f) ferrous scrap
- g) non-ferrous scrap
- h) automobile batteries
- i) white goods
- j) motor oil
- k) tires

The following facilities have been approved and permitted to accept construction and demolition materials which are to be designated as mandatory recyclable materials.

Ocean County Recycling Center, Inc.  
1497 Lakewood Road  
Dover Township  
(operating)

Ralph Clayton & Son  
515 Lakewood-New Egypt Road  
Lakewood Township  
(operating)

South Brunswick Asphalt  
Mizzen and Railroad Avenues  
Berkeley Township  
(operating)

Bil-Jim Construction/Recycling Activity Center  
RD 4, box 88  
Jackson Township  
(operating)

The following facilities have applications pending before the New Jersey Department of Environmental Protection for construction and demolition materials.

Longview Material Recovery Facility (formerly Rosetto)  
Route 37 West  
Dover Township

Brick Wall Corporation  
2215 West Lacey Road  
Lacey Township

Pinelands Recycling, Inc.  
Hay Road  
Stafford Township

The municipalities will modify their municipal ordinances no later than six months after the adoption of the Plan Amendment so as to reflect this addition of these mandated materials.

## **2.2 Dry Cell Batteries**

In the fall of 1995, the County advanced its Dry Cell Battery Management Program by distributing to municipalities containers with "Ocean County Household Battery Collection Program" stickers. The municipalities are to place the containers in appropriate locations. The County will also produce a marketing guide to provide information on additional places where batteries can be recycled. Since 1991, the County has been accepting household batteries which have been collected by the municipalities, a majority of which have collection opportunities. The collection arrangements include: containers at drop-off centers; curbside collection; distribution of collection containers at businesses generating batteries and special programs involving Scout groups and environmental groups.

In 1995, the County handled 32.37 tons of household batteries which were collected by the municipalities and marketed by the County or handled by the County's hazardous waste contractor. Both of the County's recycling facilities accept household batteries during normal hours of operation.

The County has established the following plan for increased dry cell battery recycling:

- \* Survey the municipal collection programs; produce a brochure describing the municipal programs and the reasons for recycling dry cell batteries - Fall 1996.
- \* Develop public information program, promoting Dry Cell Battery Management Program using radio PSA, newspaper advertising, newspaper press releases, cable TV advertising - Spring 1997.

- \* Mandate the collection of dry cell batteries when the receiving capacity is sufficient to ensure reliable and affordable services.

### **2.3 Vegetative Waste Management**

Since 1988, the County has provided a well equipped composting program to process vegetative materials. It is responsible for processing vegetative waste including leaves and brush at the Ocean County Northern Recycling Center in Lakewood Township and the Ocean County Southern Recycling Center in Stafford Township. The compost facility at the Southern Recycling Center is owned by Stafford Township which obtained the required permits. The County leases the site from the Township and operates the facility. In addition, the County has executed Interlocal Service Agreements with six municipalities to help them to process their vegetative waste provided they accept material from neighboring municipalities. The County's Agreement with Lacey Township states that the Lacey site is available for excess materials from other municipalities when capacity is available. The County and Lacey Township will jointly make the determination and direct municipal vehicles to the site. Available facilities accommodate ninety percent of the vegetative waste in Ocean County. Jackson Township operates its own municipal leaf composting facility. The Ocean County Northern Recycling Center Composting Facility is approved to accept grass clippings.

Since the composting program became operational in October 1988, there has not been any problem related to available capacity for leaves or brush for any municipality in Ocean County.

The County facilities processed the following quantities of vegetative materials in calendar year 1994. Both of the County's facilities have certified scales.

#### **Ocean County Northern Recycling Center**

leaves	9,417.43 tons
brush	7,668.59 tons
grass clippings	4,956.56 tons

**Ocean County Southern Recycling Center**

leaves	2,179.02 tons
brush	2,009.18 tons

Municipal facilities processed the following quantities of vegetative materials in calendar year 1994:

**Beachwood**

leaves	1,762.02 tons
brush	443.32 tons

**Brick Township**

leaves	8,831.33 tons
brush	1,014.69 tons

**Dover Township**

leaves	10,751 tons
brush	3,739 tons

**Jackson Township**

leaves	3,019 tons
--------	------------

**Lacey Township**

leaves	3,747 tons
brush	214 tons

**Lakehurst Borough**

brush	1 ton
-------	-------

**Manchester Township**

leaves	2,483 tons
brush	2,231 tons

## **Plumsted Township**

brush

10 tons

### **2.4 Recycling Estimates and Projections**

Table 1 (attached) shows that in calendar year 1994, the total solid waste material generated was 964,576 tons. The total recycled for that year was 544,889. The percent recycled was 56%. (See Figure A.)

When the source-separated organic waste compost facility is in operation, the amount of material withdrawn from the waste stream can be expected to be approximately 17% of that disposed at the Ocean County Landfill Corporation Facility (OCLF), (Analysis of Design Alternatives, Wehran, Figure 4-6). For example, in 1994, 419,687 tons were disposed of at OCLF of that total, 71,347 tons of material could have been recycled through the proposed compost system.

Therefore, the projection of recycling rates in Ocean County, based on the operation of the source-separated organic waste compost facility exceeds 60%. In 1994, assuming operation of that facility, 71,347 tons would have been composted and 544,889 tons were recycled. The total, 616,236 tons divided by the total tons of waste generated in Ocean County results in a projected recycling rate of 64%.

TABLE 1

## FINAL - PERCENTAGE OF TOTAL MATERIAL RECYCLED FOR 1994 IN TONS BY MUNICIPALITY

MUNICIPALITY	TOTAL MATERIAL GENERATED	TOTAL RECYCLED	TOTAL WASTE DISPOSED	% RECYCLED	% RECYCLED IN 1993
Barnegat	11,875.21	4,236.26	7,638.95	35.67%	26.06%
Barnegat Light	2,985.09	1,147.05	1,838.04	38.43%	22.65%
Bay Head	3,016.55	1,168.09	1,848.46	38.72%	40.43%
Beach Haven	5,058.83	877.18	4,181.65	17.34%	14.64%
Beachwood	11,307.17	5,845.48	5,461.69	51.70%	40.18%
Berkeley	72,044.69	46,766.48	25,278.21	64.91%	13.90%
Brick	123,700.70	65,784.92	57,915.78	53.18%	48.82%
Dover	236,780.78	143,614.39	93,166.39	60.65%	58.59%
Eagleswood	1,650.60	552.86	1,097.74	33.49%	23.12%
Harvey Cedars	1,592.81	343.78	1,249.03	21.58%	21.74%
Island Heights	1,879.60	723.44	1,156.16	38.49%	28.56%
Jackson	41,346.20	15,893.28	25,452.92	38.44%	44.90%
Lacey	80,598.24	61,329.29	19,268.95	76.09%	63.95%
Lakehurst	5,927.42	1,861.56	4,065.86	31.41%	48.99%
Lakewood	144,578.53	96,111.96	48,466.57	66.48%	51.08%
Lavallette	4,517.11	1,071.55	3,445.56	23.72%	10.79%
Little Egg Harbor	16,102.58	6,004.91	10,097.67	37.29%	60.00%
Long Beach	13,761.25	3,667.93	10,093.32	26.65%	17.50%
Manchester	49,696.81	28,187.77	21,509.04	56.72%	51.90%
Mantoloking	1,154.08	147.33	1,006.75	12.77%	8.38%
Ocean	6,346.90	2,197.68	4,149.22	34.63%	22.46%
Ocean Gate	2,262.49	814.42	1,448.07	36.00%	28.00%
Pine Beach	2,947.74	1,592.43	1,355.31	54.02%	64.18%
Plumsted	7,384.24	2,917.32	4,466.92	39.51%	27.47%
Point Pleasant	34,081.07	14,023.38	20,057.69	41.15%	41.82%
Point Pleasant Beac	7,568.85	2,694.13	4,874.72	35.59%	24.67%
Seaside Heights	7,694.72	2,038.90	5,655.82	26.50%	16.99%
Seaside Park	10,398.97	7,947.46	2,451.51	76.43%	66.26%
Ship Bottom	4,226.76	1,564.78	2,661.98	37.02%	18.51%
South Toms River	10,629.69	8,190.74	2,438.95	77.06%	64.51%
Stafford	28,651.91	11,304.39	17,347.52	39.45%	48.28%
Surf City	3,691.97	1,286.34	2,405.63	34.84%	32.48%
Tuckerton	7,461.59	2,981.60	4,479.99	39.96%	13.65%
Ocean County	964,576.78	544,889.08	419,687.70	56.49%	49.11%

Source: Ocean County Municipal Recycling Reporting Forms/  
Ocean County Landfill Municipal Waste Type Reports

Formula used:  $\text{TOTAL RECYCLED TONNAGE} \div \text{TOTAL RECYCLED TONNAGE} + \text{TOTAL WASTE DISPOSED} \times 100$

Note: Deductions were made from the following towns from their total waste disposed for "grit" tonnage from the OCUA facilities:

Berkeley - 896.85  
Brick - 502.59  
Stafford - 256.19

Note: The Department of Solid Waste Management has included the 1993 recycled bulky commercial tonnage for each municipality, if any, reported to the NJDEP from the ISRI/AMRA organizations since this data is not reported to the municipalities. The 1994 ISRI/AMRA data is not available from NJDEP at the present time, so the previous year's data will serve as the best estimate until NJDEP can have this data available in a timely manner. The ISRI/AMRA pro-rated data was inputted with the fourth quarter data.

FIGURE A

PERCENTAGE OF TOTAL MATERIALS RECYCLED IN OCEAN COUNTY BY MUNICIPALITY

FINAL - 1994

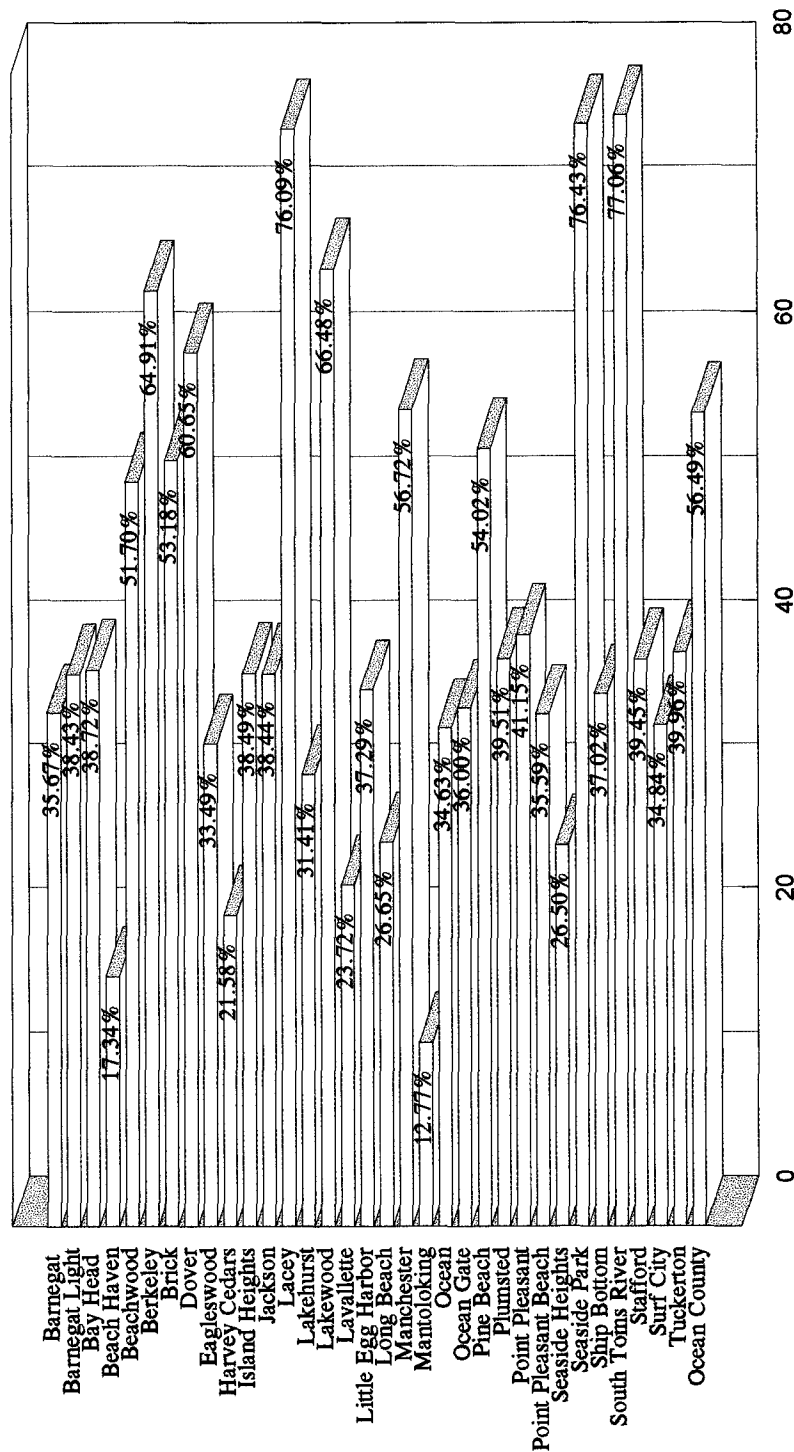

Total Recyclables = 544,889.08 tons. Prepared by: Ocean County Dept. of Solid Waste Management

Source: Ocean County Municipal Recycling Reporting Forms & Ocean County Landfill Corp. Municipal Waste Type Reports



### **Section 3**

#### **Source Reduction**

The NJDEP requested in its January 14, 1993 Certification of the County's Plan Amendment that the County describe the results of its public education program for source reduction, develop a waste audit program at all County and municipal buildings and consider the implementation of a per-container rate program.

#### **3.1 Public Education Program**

##### **\* Posters/Brochures - Grass Clippings**

Public awareness has been increased for the possible future reduction of grass clippings received at the Ocean County Landfill, Inc. through the expansion of the County's "Cut It and Leave It" campaign. This has included the distribution by the County of the New Jersey Department of Environmental Protection's, "Cut It and Leave It" posters and brochures on lawn care and use of mulching mowers. The posters were provided to the Jersey Shore Landscapers' Association and the 33 municipalities for their further distribution locally. The brochures have been distributed to all the adult communities in Ocean County.

##### **\* Mulching Mowers**

The District Recycling Coordinator met with the area's landscapers in October, 1992, and continues to do so each spring, to discuss the critical problems that grass clippings are causing in landfill facilities and to encourage the use of mulching mowers. A presentation of the Toro "Recycler" mulching mower was provided to the municipal recycling coordinators. Bid specifications have been modified so that additional mulching mowers can be purchased by the various County departments. The Building and Grounds Department has purchased them and has converted regular mowers. They have reported favorable results. Large landscaping companies and some smaller

companies are using the mulching mowers and there has been a decrease in disposal problems since 1992. The County has also recorded a decrease in grass clippings delivered at its compost site at the Northern Recycling Center.

**\* Recycling Newsletter**

A quarterly newsletter, "Ocean County Recycles", is prepared by the Department of Solid Waste Management. It includes articles on composting, tire recycling, grasscycling, the use and handling of household hazardous waste products for the consumer, the use of recycled products such as plastic lumber and book recycling. Additional attention will be given to source reduction by a series of articles on environmental shopping guidelines for the consumer, alternative uses for certain products, the sharing of leftover products with neighbors, such as paint. This newsletter is mailed to County residents, local officials, buildings, Chambers of Commerce, conservation and environment organizations, environmental commissions, garden clubs, hospitals, libraries, local beach and yacht clubs, various municipal departments, campgrounds, schools, adult community groups and women's clubs.

**\* Informational Material for Schools**

The school curriculum produced by the New Jersey Department of Environmental Protection entitled Here Today, Here Tomorrow has been distributed to all of the County's school districts. A curriculum for solid waste awareness produced by the EPA entitled Let's Reduce and Recycle was also distributed to the municipalities. A video and curriculum guide entitled, "Ocean County Recycles" was produced by the County's consultant, Wolcott Communications Group, Inc. This guide addresses all aspects of the County's Recycling Program. Staff worked with the Environmental Education Network, a local group comprised of teachers and students, on this project which was funded by the County's 1989 Recycling Public Education Grant. The

video and curriculum guide were distributed to all public and private schools prior to the 1995/1996 school year.

In September 1993, the County purchased 75,000 book covers for distribution to elementary, secondary and high school level students for all of the County's school districts. The covers display information on recycling and source reduction. The County's recycling logo is incorporated on the book covers as well.

**\* Portable Exhibit**

A portable exhibit has been purchased for use at fairs, conferences and other events to present the County's solid waste management programs on recycling, composting, household hazardous waste and source reduction. Photos, graphs and statistical data have been presented.

**\* Environmental Shopping Task Force**

In the spring of 1993, the County developed an Environmental Shopping Task Force in cooperation with the Ocean County Women's Commission. This Task Force includes municipal recycling officials, the League of Women Voters, environmental organizations, Cooperative Extension Service, the County Planning Board and the County Library. The Task Force is a cooperative effort to raise awareness about environmental shopping. The production of an environmental shopping guide on source reduction that has been completed by the local Environmental Education Network. The guide features the following topics:

- a) Buying products made from recycled materials.
- b) Alternatives to household hazardous waste products.
- c) Healthful foods.
- d) Packaging choices.

Other activities that are proposed are the development of environmental shopping guidelines for consumers, product testing, alternative product demonstrations and the recommendation to the Ocean County Library that they have books available for the consumer on environmental shopping. Workshops, forums and a speakers bureau were also developed.

**\* Household Hazardous Waste**

The County has distributed 30,000 Household Hazardous Waste Wheels, an easy to use guide on the proper handling and disposal of household hazardous waste products. These wheels are produced by the Environmental Hazards Management Institute, New Hampshire. They were distributed to the participants of the County's Household Hazardous Waste Collection Programs during 1991 and 1992. The guide also includes information on product alternatives.

The County utilized funds from its 1992 Recycling Public Education Grant to purchase 10,000 Home Inventory Guides for Responsible Care of Hazardous Household Products. This generic guide, also produced by the Institute, encourages homeowners to consider alternative non-hazardous products and to buy only the quantities needed to complete the task. The guides have been distributed to the participants of the County's Household Hazardous Waste Collection Program in 1993 and 1994.

**\* Speakers Directory**

An Ocean County Environmental Speakers Directory was established early in 1995. Volunteer members bring extensive speaking experience and knowledge of a variety of environmental topics to the residents of Ocean County. Members are of invaluable assistance in furthering public education by responding to speaking requests from schools, service organizations, like the Rotary and Kiwanis, and civic organizations such as garden clubs, historical societies and senior citizens' groups throughout Ocean County.

The goals of the organization of the directory are to offer a listing of knowledgeable speakers who will:

- a) familiarize the public with environmental topics and issues in Ocean County.
- b) assist the public in learning more about specific environmental aspects of Ocean County such as ecology, plants, animals and resources.

**\* Billboard Advertising**

Funding from the 1992 Recycling Public Education Grant was utilized to develop a billboard advertising campaign that focused on "Environmental Shopping". Billboards were rented along high trafficked areas to promote this campaign in the Fall of 1994.

**\* Source Reduction - Poster/Brochure**

A poster and brochure will be developed that will advise residents on how they, as consumers, can decrease their generation of waste. This product will be completed by the fall of 1996.

**\* Purchase of Promotional Material**

The County has available promotional items to increase awareness for source reduction and recycling. Items such as environmental shopping tote bags, pens, pencils, rulers, mugs, coloring books, recycling guides and calendars are made available for distribution at County events and to visitors touring the County's MPF. All of these items have recycled content.

**\* 1-800-55-RECYCLE**

The 24-hour Solid Waste Informational Phone Line, 1-800-55-RECYCLE, is part of the ongoing public education program devised by the Ocean

County Board of Chosen Freeholders, in conjunction with the Department of Solid Waste Management in responding to the mandate of responsible, environmentally safe waste disposal.

Hot line information includes specifics on household hazardous waste, asbestos and white goods collection. Instructions on location hours and materials accepted at the two regional County recycling centers are also provided. By dialing the hot line, a recording will advise callers on the proper recycling or disposal of waste oil, tires, batteries, grass/leaves, brush, compost/mulch, telephone books and Christmas trees. A number to report illegal dumping is also included, 1-800-535-DUMP.

### **3.2 Per Container Rate**

The County distributed in February 1993 a Refuse Collection and Disposal Survey to the mayor and public works director of each municipality to determine existing solid waste collection costs and practices of the 33 municipalities. The data collected helps the Solid Waste Advisory Council with plans for the further expansion of recycling and composting. The data will also assist the County in considering per container rates. The County's solid waste consultant, Elson T. Killam Associates, has compiled a report analyzing the data collected from the survey. The County will share its evaluation of collection costs and provide technical information to its municipalities on the use of per container rates.

One municipality, the Township of Plumsted, through a carter has operated a Per Container Rate Program since 1992. The Township officials have reported that they have been satisfied with the program to date.

The County does not provide collection of either solid waste or recyclables. If the per container rate approach is adopted it will be the choice of the municipality.

### 3.3 Procurement Policy

Because of the quantities of goods purchased by County government, there is an opportunity for the County to make a significant long-term contribution to the market for recycled materials through preferential procurement.

Several County Agencies Are Involved:

- \* The County Engineer regularly issues bid specifications which require recycled products including:
  - a) glassphalt
  - b) concrete aggregate
  - c) compost products
- \* The County Purchasing Department routinely purchases the following recycled products:
  - a) paper for the Printing Department and other County departments and agencies.
  - b) tissue products
  - c) stationery
- \* The County Vehicle Maintenance Department has purchased an antifreeze recycling system which has reduced demand for new antifreeze and reduced disposal problems for antifreeze.
- \* The County Recycling Centers produce significant quantities of compost and mulch which are provided free and used by the following:

<u>Organization</u>	<u>Compost</u>	<u>Root Mulch</u>
Ocean County Road Department	6511.55 tons	92.52 tons
Ocean County Parks Department	16.06 tons	292.30 tons
Ocean County Buildings & Grounds	0.00 tons	21.53 tons
Municipalities	1056.21 tons	336.54 tons
Landscapers & Homeowners	3519.86 tons	528.74 tons

- \* The Manager of the Warehouse maintains a list of all products currently available which are made from recycled materials, starting August 1, 1993.
- \* The County has established a Recycling Procurement Committee consisting of staff from the following County departments: Purchasing, Solid Waste Management, Engineering, Roads, Printing and Parks and Recreation. Bids for supplies will be evaluated by the Committee to determine any possibilities to obtain products made from recycled materials. Where available, recycled products will be bid - to be in place, January, 1997.

Procurement has frequently been discussed during the monthly Municipal Recycling Coordinators' Meeting. Copies of the State Procurement Guide were distributed to the municipalities by the County. The County will survey each of the municipalities to obtain data on the types of recycled products being procured.

#### **3.4 Waste Audits**

In the fall of 1992, the County distributed a booklet produced by the Association of New Jersey Recyclers entitled Small Business Guide to Cost Effective Recycling to its municipal recycling coordinators for distribution to their commercial establishments and to the private hauling firms for distribution to their customers. The guide provides simple, clear directions on how retail businesses and offices can estimate their trash volume and disposal costs, determine what materials have recycling value, conduct waste audits, and set up a recycling program. There has not been a strong response from the municipalities to conduct waste audits. The County will request the cooperation of its municipalities, along with the participation of the private hauling firms and the local Chambers of Commerce, to develop the program. For example, the Lakewood Chamber of Commerce is in the process of working with the businesses within the Lakewood Industrial Park to conduct waste audits. Several haulers have offered to perform waste audits for their customers as a service.



Waste Audits for Government Offices - The County initially installed indoor and outdoor recycling containers for all of its buildings and facilities in 1988. For the new office building that houses the Election Board and the Planning, Solid Waste, Road and Engineering Departments, new office recycling containers were installed in June, 1993, to encourage more recycling of office paper, commingled bottles and cans, newsprint and batteries. Each work station includes a recycling container for office paper. Outside areas and the County's new parking garage will also have recycling containers in place. This model office recycling program will continue to be an example for County departments, municipal offices, institutions and private businesses to adopt more aggressive office recycling programs. New County buildings and facilities and those undergoing substantial rehabilitation now incorporate this model program in initial design. The County will require the cooperation of its offices to complete waste audits in the fall of 1996. Municipal buildings will be encouraged to complete waste audits in the following year.

### **3.5 Grass Clippings**

The County supports the "Cut It and Leave It" concept as a source reduction method for grass clippings. The County has completed the following activities:

- \* During each of the past three years, meetings were held in the spring with the Jersey Shore Landscapers' Association to promote "Cut It and Leave It" lawn care. Progress has been made and the number of professional landscapers using mulching mowers has increased.
- \* The County obtained a free "recycler" mower from Toro and conducted demonstrations at the Ocean County Courthouse Complex. The results were provided to the municipalities.
- \* The County lawn mower bid now includes several varieties of recycler mowers.

- \* The County implemented a backyard composting program that included grass clippings as a targeted material. The County purchased "Earth Machine" backyard composting units in the spring of 1995 and distributed them to interested municipalities who agreed to establish an educational and documented program.

Before the distribution of the units, the County offered a mandatory backyard composting training workshop for the participating municipalities. As part of the training workshop, the County distributed short surveys (Figure B) for the municipal officials to give to participating residents to complete and return to the County to monitor the performance of the "Earth Machine" units. The surveys received to date have been very positive about the unit and the practice of backyard composting. The participants liked the idea that backyard composting was easy, reduced their trash and protected the environment. Participants also reported favorable results with the compost product they received from their backyard composting efforts.

**FIGURE B**  
**EARTH MACHINE SURVEY**

1. How do you like the "Earth Machine" backyard composter, such as the physical components? \_\_\_\_\_  
\_\_\_\_\_
2. Is it easy to operate? If not, what are the problems? \_\_\_\_\_  
\_\_\_\_\_
3. Did your town offer a training workshop on the use of the unit? If yes, was the training beneficial? \_\_\_\_\_
4. How frequently do you use the unit? \_\_\_\_\_
5. What materials did you primarily place inside the unit for composting? \_\_\_\_\_  
\_\_\_\_\_
6. How often do you stir the material in the unit? \_\_\_\_\_
7. Have you encountered any odor problems with the material in the unit? \_\_\_\_\_
8. Have you experienced any other problems with the use of the unit? \_\_\_\_\_  
\_\_\_\_\_
9. What was the quality of the finished compost product from the unit? \_\_\_\_\_  
\_\_\_\_\_
10. Provide the best estimate of how much of your kitchen waste has been reduced with the use of the unit in a week's time or monthly basis. \_\_\_\_\_
11. Has the finished compost product worked well with your garden, plantings, etc.? \_\_\_\_\_
12. Were you satisfied with the performance of the unit? If not, why not? \_\_\_\_\_  
\_\_\_\_\_
13. How would you describe your interest in backyard composting? \_\_\_\_\_  
\_\_\_\_\_

**Participants must return the completed survey by October 1, 1995 to: Ms. Kathleen Avery, Assistant District Recycling Coordinator, Ocean County Department of Solid Waste Management, P.O. Box 2191, Toms River, New Jersey 08754.**

*Thank you for your cooperation!*

### 3.6 Household Hazardous Waste

The Ocean County Board of Chosen Freeholders has sponsored "Household Hazardous Waste" programs since 1989 in order to provide residents the opportunity to rid their homes of common hazardous household products. Since 1989, the program has grown dramatically. Each year the County offered either four or six collection days. The graph (Figure C - Ocean County Household Hazardous Waste Collection Program - Quantities and Costs) identifies the growth of the program in terms of pounds of materials handled and costs per year.

In 1993, the program was revised to eliminate the long lines and waiting time and to make the program otherwise more convenient. The Spring 1994 Program consisted of eighteen days at ten municipal sites with weekday, evening and Saturday hours. County residents were required to preregister and participants were limited to 25 per hour. This system also provided the County with a mechanism to control significant cost increases.

The program was a cooperative effort with the municipalities - they provided the site and manpower to assist with checking registrations and weighing of the drums.

The County initiated a paint can recycling program for individuals, municipalities and retirement communities in late summer of 1993. For a period of eight days, individuals could drop off empty paint cans. The program was so successful that both of the County Regional Recycling Centers now accept empty paint cans, five days per week from 7:30 a.m. to 3:00 p.m. The County Northern Recycling Center also accepts empty paint cans on Saturdays from 7:30 a.m. to 3:00 p.m. Empty aerosol cans are now part of the commingled curbside recyclables.

The County has been evaluating the opportunities to establish a permanent facility to accept household hazardous waste from County residents. The County has taken the following steps:

- \* Reviewed permit requirements.
- \* Held meetings with several equipment vendors to discuss program options and issues.
- \* Met with representatives of the Ocean County Landfill Corporation to discuss several issues related to having a permanent facility at the landfill.
- \* Held several planning meetings to discuss funding mechanisms for a permanent facility.
- \* Visited permanent household hazardous waste facilities.
- \* Monitored the progress of Burlington and Monmouth Counties in their efforts to establish such a facility.
- \* The County will investigate the opportunities to develop a paint recycling program in 1996. This investigation will consist of meetings with representatives of existing programs, companies offering paint recycling programs and paint manufacturers.

The County has defined the following milestones for the establishment of its facility:

- \* Prepare a preliminary proposal for review by the Ocean County Solid Waste Advisory Council - November 1996.
- \* Propose a Plan Amendment to establish a permanent program and facility - January 1997.
- \* Permit applications to be submitted - August 1997.
- \* Facility operational - Spring 1998.

The County is evaluating the potential of expanding the Household Hazardous Waste Program to include small quantity generators. The County's contractor would be set up at selected facilities and small quantity generators would pay for disposal. The program would be expected to save small businesses on the cost of disposal.

The Ocean County Counsel's office is evaluating the liability risks of adding small quantity generators.

FIGURE C

**OCEAN COUNTY HOUSEHOLD HAZARDOUS WASTE COLLECTION PROGRAM  
QUANTITIES AND COSTS**

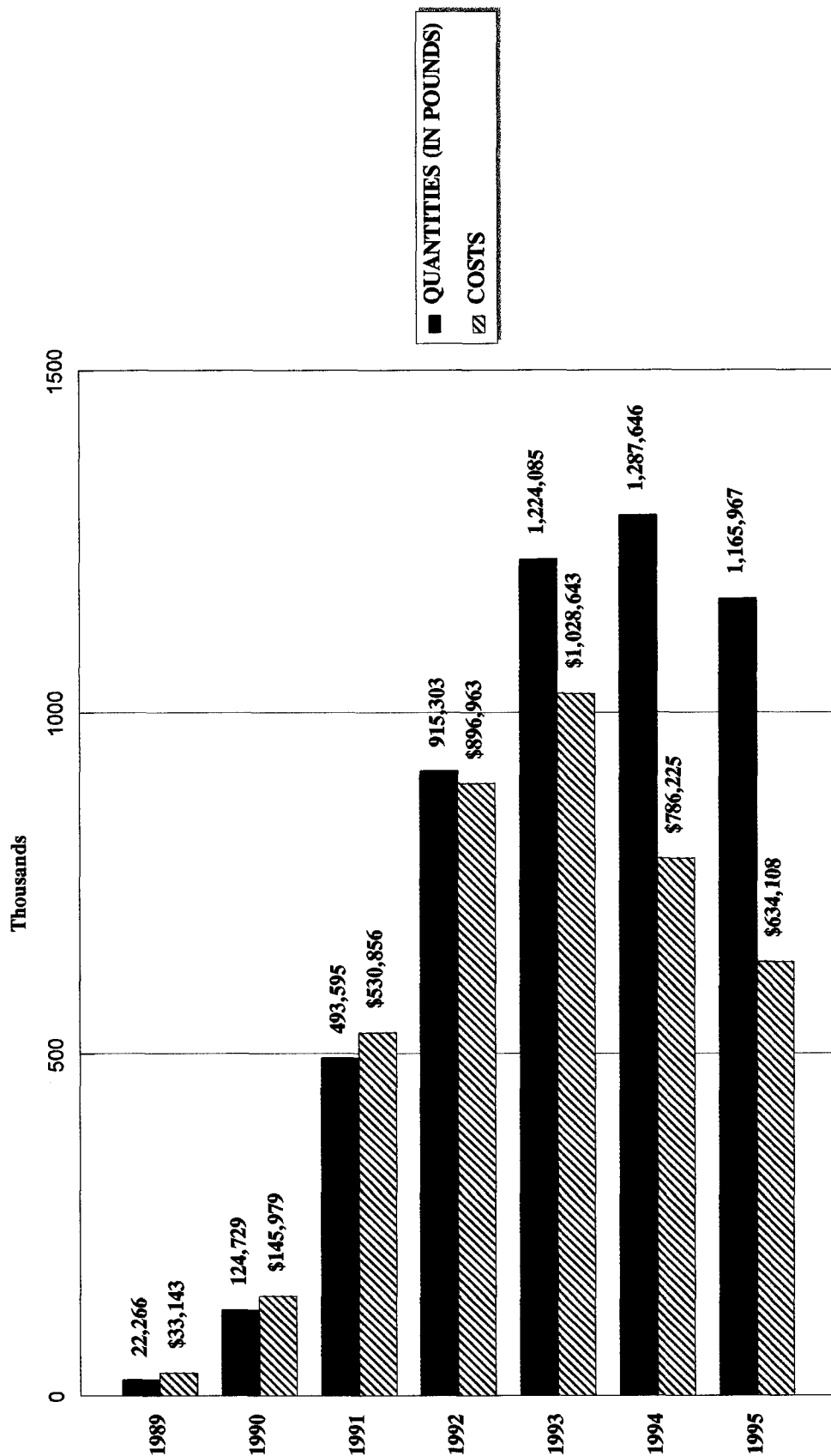

NOTE: 1989 DATA REPRESENTS SPRING PROGRAM ONLY  
Prepared by: Ocean County Dept. of Solid Waste Management

**Section 4**  
**PLAN APPROVED FACILITIES**

**4.1 Dover Township Public Works Facility**

In September of 1994, the County entered into discussions with the Township of Dover regarding planned improvements to the Township's Public Works Facility. The Township proposed an addition to their existing building that would accomplish the following:

- \* Permit the indoor storage of recyclables prior to transfer to the Ocean County Northern Recycling Center for processing to improve litter control, site conditions and reduce weathering of recyclables.
- \* Improve the collection of municipal solid waste within the Township by providing an ability to transfer solid waste from collection vehicles to larger vehicles for delivery to the Ocean County Landfill.
- \* Provide for additional indoor storage of vehicles and equipment.

Under Department regulations such a facility as proposed is considered a transfer station requiring inclusion in the District Solid Waste Management Plan. The County subsequently received an application from the Township of Dover for the inclusion of a transfer station for source-separated recyclable materials and Waste Type 10, to be designed, constructed and operated by Dover Township at Tax Lots 10 & 11, Block 231, Dover Township, Ocean County, New Jersey. (See map in Appendix II).

The application was presented to the Solid Waste Advisory Council at its meeting of June 26, 1995. SWAC recommended inclusion of the facility for receiving source separated recyclable materials and Waste Type 10 consistent with an Agreement between the Township of Dover and the County setting forth the terms and conditions of facility operation. In summary, the Agreement provides for the delivery of all mandatory recyclable materials generated from the residential sector of Dover Township to the Ocean County Northern Recycling Center in Lakewood Township. Waste Type



10 will be delivered to the Ocean County Landfill, Manchester Township. The facility will solely serve the Township of Dover and it will not be open to other municipalities in the County. The Dover Township facility is hereby included within the Ocean County District Solid Waste Management Plan contingent upon the terms and conditions contained in the Agreement. The Agreement between Dover Township and Ocean County is contained in Appendix III of the Plan Amendment and is made a part of the Ocean County District Solid Waste Management Plan.

#### **4.2 Lacey Compost Facility**

The Ocean County Board of Chosen Freeholders and the Township of Lacey entered into an Interlocal Service Agreement in the fall of 1995. As part of the Agreement, the County will process leaves and brush at the existing permitted Lacey Township site. The Lacey Township Facility will be available to the municipalities when capacity is available and will be available for municipal vehicles only, as determined by the County of Ocean and Lacey Township.

#### **4.3 Tuckerton Sand and Gravel Landfill**

The Mathis Landfill also known as the Tuckerton Sand and Gravel Landfill is closed. This facility is hereby deleted from the Ocean County District Solid Waste Management Plan.

#### **4.4 Ocean County Landfill Corporation Landfill**

The February 1991 Amendment to the Ocean County Solid Waste Management Plan designated Block and Lot numbers in Manchester Township for the Ocean County Landfill Corporation (OCLF) Landfill. These areas were further identified by the intended use by OCLF (i.e. disposal, processing, buffer, etc.). Since that time additional properties have been acquired by OCLF to extend the buffer area. The following Blocks and Lots are incorporated into the Ocean County District Solid Waste Management Plan for buffers only:

Block 3, Lots 635, 636, 637 and 638 - 4.3 acres

Block 3:03, Lots 1 - 8.78 acres

**4.5 Ocean Gate Transfer Station**

The permit for the Ocean Gate Transfer Station was revoked by the New Jersey Department of Environmental Protection's Division of Solid Waste Management and the facility reclassified as a "convenience center". Such an operation is not subject to New Jersey Department of Environmental Protection facility requirements. The transfer station facility is hereby deleted from the Ocean County District Solid Waste Management Plan.

**4.6 Toms River Veterinary Hospital**

The small incinerator formerly used for animal carcasses at the Toms River Veterinary Hospital is closed. This facility is hereby deleted from the Ocean County District Solid Waste Management Plan.

**4.7 Ocean County Utilities Authority**

The small incinerator formerly used for grease and sludge oil at the Ocean County Utilities Authority central plant is closed. This facility is hereby deleted from the Ocean County District Solid Waste Management Plan.

**Section 5**  
**OCEAN COUNTY LANDFILL COMPOST FACILITY**

In the Plan Amendment approved by the Board of Chosen Freeholders in February 1991, composting was designated as the selected technology to process compatible wastes. The Plan further said that a portion of the waste stream then entering the landfill "...will be composted reducing the amount of waste landfilled and producing a useful end product." (page 28).

That same Plan Amendment designated the Ocean County Landfill as the site for the regional composting facility.

Those principles and designations were preserved in the August 1992 Amendment and remain intact.

However, early assumptions were that non-recyclable household waste would be the raw material for the compost facility and that there would be front-end separation of non-compostables. Detailed studies of design alternatives for the Ocean County Landfill waste management facility were performed by Wehran Engineering Corporation on behalf of the Ocean County Landfill. The results of those studies were reported by Wehran in November 1992: Analysis of Design Alternatives. For the reasons stated in the report, mostly relating to lower construction and operating costs, higher product quality and lower risk, Wehran recommended Alternative 4. This consisted of a compost facility for source-separated organic wastes. The raw material would derive from separated household kitchen wastes at the curb and from restaurants and other commercial food-handling establishments. Separation of household organics will be a voluntary program. The tip fee at the Ocean County Landfill will be lower for source-separated organic wastes in order to provide an incentive for delivery of this material.

The recommendation of this Alternative was accepted by the owner, by the Ocean County Solid Waste Advisory Council and by the Board. It is the defined choice in this Plan.

This change from the anticipated composting of mixed municipal solid waste alters the projected tonnages of compost product and of the recyclables that were to have been separated at the front end. Wehran Engineering corporation in its November 1992 report (Figure 406) projected for the year 2000 that 423,701 tons of material would be delivered to the Ocean County Landfill. With the bio-waste compost facility in operation, 72,492 tons would be withdrawn from the waste stream for compost. (ibid) This represents 17% recycling of household waste attributable to the compost process. (See Table 2 for quantities of material received at the landfill.)

TABLE 2

Waste Materials Received at the Ocean County Landfill in 1994  
by Waste Types and Municipality of Origin

MUNICIPALITY	TYPE 10	TYPE 12	TYPE 13	TYPE 23	TYPE 25	TYPE 27	OTHER	TOTAL
Barnegat	6,936.15	0.00	702.80	0.00	0.00	0.00	0.00	7,638.95
Barnegat Light	1,578.59	0.00	259.45	0.00	0.00	0.00	0.00	1,838.04
Bay Head	753.55	0.00	1,094.91	0.00	0.00	0.00	0.00	1,848.46
Beach Haven	3,884.59	0.00	285.97	0.00	0.00	11.09	0.00	4,181.65
Beachwood	5,056.71	0.00	404.98	0.00	0.00	0.00	0.00	5,461.69
Berkeley	22,246.21	0.00	3,108.33	0.00	0.00	820.52	0.00	26,175.06
Brick	45,507.03	0.00	12,370.47	0.22	3.21	537.44	0.00	58,418.37
Dover	73,204.37	0.00	19,962.02	0.00	0.00	0.00	0.00	93,166.39
Eagleswood	979.68	0.00	118.06	0.00	0.00	0.00	0.00	1,097.74
Harvey Cedars	1,050.95	0.00	198.08	0.00	0.00	0.00	0.00	1,249.03
Island Heights	1,066.73	0.00	89.43	0.00	0.00	0.00	0.00	1,156.16
Jackson	19,201.91	0.00	6,118.08	0.00	0.00	132.93	0.00	25,452.92
Lacey	16,934.94	0.00	2,159.82	0.00	174.19	0.00	0.00	19,268.95
Lakehurst	1,707.08	0.00	2,253.68	0.00	0.00	105.10	0.00	4,065.86
Lakewood	39,697.49	0.00	8,639.86	0.00	0.00	129.22	0.00	48,466.57
Lavallette	2,595.54	0.00	850.02	0.00	0.00	0.00	0.00	3,445.56
Little Egg Harbor	9,321.63	0.00	776.04	0.00	0.00	0.00	0.00	10,097.67
Long Beach	7,732.83	0.00	2,360.49	0.00	0.00	0.00	0.00	10,093.32
Manchester	13,582.61	0.00	7,926.43	0.00	0.00	0.00	0.00	21,509.04
Manoloking	479.28	0.00	527.47	0.00	0.00	0.00	0.00	1,006.75
Ocean	3,726.34	0.00	422.88	0.00	0.00	0.00	0.00	4,149.22
Ocean Gate	1,152.99	0.00	295.08	0.00	0.00	0.00	0.00	1,448.07
Pine Beach	1,193.36	0.00	161.95	0.00	0.00	0.00	0.00	1,355.31
Plumsted	3,546.92	0.00	920.00	0.00	0.00	0.00	0.00	4,466.92
Point Pleasant	17,162.26	0.00	2,895.43	0.00	0.00	0.00	0.00	20,057.69
Point Pleasant Beach	4,207.86	0.00	666.86	0.00	0.00	0.00	0.00	4,874.72
Seaside Heights	4,302.45	0.00	1,353.37	0.00	0.00	0.00	0.00	5,655.82
Seaside Park	1,924.55	0.00	526.96	0.00	0.00	0.00	0.00	2,451.51
Ship Bottom	2,321.63	0.00	340.16	0.00	0.19	0.00	0.00	2,661.98
South Toms River	2,274.85	0.00	164.10	0.00	0.00	0.00	0.00	2,438.95
Stafford	14,185.27	0.00	3,079.57	0.00	0.00	338.87	0.00	17,603.71
Surf City	2,017.29	0.00	388.34	0.00	0.00	0.00	0.00	2,405.63
Tuckerton	3,014.06	0.00	1,465.93	0.00	0.00	0.00	0.00	4,479.99
Total	334,547.70	0.00	82,887.02	0.22	177.59	2,075.17	0.00	419,687.70

Source: Ocean County Landfill Municipal Waste Type Tonnage Reports

Type 10 = municipal waste  
Type 12 = dry sewage sludge  
Type 13 = bulky waste  
Type 23 = vegetative waste  
Type 25 = animal/food processing waste  
Type 27 = dry industrial waste

**Section 6**  
**RESOURCE RECOVERY INVESTMENT TAX FUND**

N.J.S.A. 13:1E-138 (L.1985 c38 effective May 1, 1985) imposed a resource recovery investment tax upon the owner or operator of every sanitary landfill facility. The tax was set at \$1 per ton rising to \$4 in the third year. The revenue created the Resource Recovery Investment Tax Fund payable to counties to subsidize the costs of all forms of solid waste resource recovery processes. N.J.S.A. 13:1E-150 required that each county, as part of its District Solid Waste Management Plan, prepare a plan to define its proposed uses of the Investment Tax Fund.

In the August 4, 1992 Amendment to the Ocean County District Solid Waste Management Plan, a plan was prepared and adopted covering the proposed uses of the Investment Tax Fund. This plan called for the reimbursement to the County of \$12,445,000 of County funds associated with the construction of the Northern and Southern Recycling Centers. Additionally, the Plan authorized the use of the fund for capital and operating costs to be incurred in the future by the County Recycling and Household Hazardous Waste Programs.

As of December 31, 1995, the Resource Recovery Investment Tax Fund has a balance of \$7,381,316. The County has previously obtained approval for reimbursement of past expenditures related to the construction of the County Recycling Centers. With this Plan Amendment, the County wishes to use the proceeds from the fund to reimburse the County for past engineering consulting cost associated with the construction of the County Recycling Centers in the amount of \$1,000,000. These costs were incurred prior to the adoption of the August 4, 1992 Plan Amendment and therefore, are not currently eligible for reimbursement from the fund. Future use of the fund will continue as detailed in the previous Plan Amendment.

## Section 7

### REGIONALIZATION

The January 14, 1993, DEPE Certification of the County Plan required the County to discuss in its next Amendment the results of its discussions on regionalization with other counties. The Board of Freeholders does not want to utilize the limited availability of landfill space for imported waste because this would conflict with the objectives of the County Plan. Meetings have been held with Warren, Monmouth, Middlesex, Passaic, Atlantic, Burlington and Somerset Counties concerning their plans to meet the regionalization requirements of the State. These meetings indicate that there is interest in inter-county arrangements for handling household hazardous waste to provide more efficient and economical service for the public. Other counties also expressed interest in the sharing of facilities for the processing of recyclables.

The most logical and likely form of inter-county management for Ocean County is the continued processing in its facilities of recyclables generated elsewhere.

The County's Recyclable Materials Processing Facility (MPF) in Lakewood Township has accepted out-of-county material since March 1992. In 1993, the facility accepted commingled residential recyclables from Camden, Cape May, Monmouth, Mercer and Somerset Counties amounting to 9,795 tons. The private recycling facilities included in the District Plan that process construction and demolition waste, wood waste, used concrete and asphalt are accepting or plan to accept out-of-county material. The County does not place any restrictions upon these facilities in regard to the amount of out-of-county material they can accept. Section 2.1 presents a listing.

## Section 8

### MEDICAL WASTE

Medical Waste is regulated by its own special statute: Comprehensive Regulated Medical Waste Management Act (N.J.S.A. 13:1E-48.1 et. seq.). This statute, which was enacted in 1989, was a supplement to the Solid Waste Management Act (N.J.S.A. 13:1E-1 et. seq.).

Under the terms of this law the Department of Environmental Protection, assisted by the Department of Health, is the primary administrator and enforcer.

The Department of Environmental Protection, as required by the statute, prepared a draft Comprehensive Regulated Medical Waste Management Plan, April 1993. The Plan has not been adopted and is used only as guidance.

The law provides that each county which has a shortfall of medical waste disposal capacity "...shall provide for the regulated medical waste disposal requirements of the county as determined by the Department..." (13:1E-48.16(a)). The county must prepare an amendment to its Solid Waste Management Plan in order to present the disposal arrangements which have been devised for current use and for the future. By a letter of May 25, 1994, the Commissioner of Environmental Protection asked all counties to submit their Plans by December 31, 1994.

Through its waste tracking system, the Department of Environmental Protection has been able to compile detailed statistics as to the form, quantities and disposal arrangements for regulated medical waste generated in New Jersey.

According to the Department of Environmental Protection, 20,154 tons of RMW were generated in 1992 by 12,599 generators.

In 1993, there were a total of 711 generators in Ocean County generating a total of 890 tons (see Table 3). Of this amount, 809 tons were generated by five hospitals (see Table 4).



Table 3

## OCEAN COUNTY - 1993 AGR DATA - PRELIMINARY DATA

062 - HOSPITALS

Oct 4, 1994

ID#	BUS	ADDR1	CITY	CONTACT	TEL	TOTAL POUNDS	TOTAL TONS
038072	COMMUNITY MEDICAL CENTER	99 HWY 37 WEST	TOMS RIVER	NEIL J BRYANT	908-240-8000	796,722	398.361
054461	SOUTHERN OCEAN COUNTY HOSPITAL	1140 W. BAY AVENUE	MANAHAWKIN	CHUCK SMITH	609-597-6011	111,195	55.597
068529	KIMBALL MEDICAL CENTER	600 RIVER AVE	LAKEWOOD	PAUL STROUT	908-363-1900	339,901	169.950
099228	MEDICAL CENTER OF OCEAN CO	425 JACK MARTIN BLVD BRICK	BRICK	JOHN HOPLER	201-840-2200	119,501	59.750
101855	MED CTR OCEAN CO/PT PLEASANT DIV	2121 EDGEWATER PLACE	POINT PLEASANT	JOHN HOPLER	201-892-1100	251,409	125.704
131555	COMMUNITY MED CTR (BEACH ANNEX)	99 HIGHWAY 37 WEST	TOMS RIVER	X3210 N J BRYANT	201-240-8000	10	0.005
131564	COMMUNITY MED CTR (MANAHAWKIN)	99 HIGHWAY 37 WEST	TOMS RIVER	NEIL J BRYANT	609-597-1072	36	0.018
133706	MANAHAWKIN CONVALESCENT CENTER	1211 ROUTE 72 WEST	MANAHAWKIN	WIN SNYDER/S MCVAY	609-597-8500	29	0.014
Total:						1,618,803	809.401

OCEAN COUNTY 1993 AGR DATA - PRELIMINARY DATA  
 NO OF GENERATORS, BY SIC CODE  
 Oct 4, 1994

Table 4

SIC DESCRIPTION	TOTAL POUNDS	TOTAL TONS
0741-0742 - Veterinary Services		
Total:	3,284	1.6420
Count:	28	
7261 - Funeral Services		
Total:	24,348	12.1740
Count:	22	
8011 - Doctors of Medicine		
Total:	25,360	12.6800
Count:	290	
8021 - Dentists Offices		
Total:	6,152	3.0760
Count:	178	
8031 - Osteopathy Offices		
Total:	1,957	0.9785
Count:	12	
8043 - Podiatrists Offices		
Total:	368	0.1840
Count:	37	
8049 - Health, Practitioners		
Total:	81	0.0405
Count:	3	
8051 - Skilled Nursing Care		
Total:	1,631	0.8155
Count:	23	
8052 - Intermediate Care Facilities		
Total:	128	0.0640
Count:	4	
8059 - Nursing & Personal Care Facilities		
Total:	17	0.0085
Count:	3	
8062 - General Medical & Surgical Hospitals		
Total:	1,618,803	809.4015
Count:	8	
8063 - Psychiatric Hospitals		
Total:	318	0.1590
Count:	1	
8069 - Specialty Hospitals		
Total:	940	0.4700
Count:	2	
8071 - Medical Laboratories		
Total:	11,561	5.7805
Count:	13	
8082 - Home Health Care Services		
Total:	629	0.3145

Table 4  
(continued)

OCEAN COUNTY 1993 AGR DATA - PRELIMINARY DATA  
NO OF GENERATORS, BY SIC CODE  
Oct 4, 1994

SIC DESCRIPTION	TOTAL POUNDS	TOTAL TONS
Count:	10	
8092 - Kidney Dialysis Centers		
Total:	71,849	35.9245
Count:	1	
8093 - Specialty Outpatient Facilities		
Total:	139	0.0695
Count:	5	
8099 - Health & Allied Services		
Total:	346	0.1730
Count:	2	
8211 - Elementary & Secondary Schools		
Total:	178	0.0890
Count:	60	
8221 - Colleges, Universities & Professional Schools		
Total:	269	0.1345
Count:	3	
8734 - Commercial Testing Labs		
Total:	10,727	5.3635
Count:	1	
9229 - Public Safety		
Total:	1,050	0.5250
Count:	2	
9431 - Health Departments		
Total:	120	0.0600
Count:	1	
MISCELLANEOUS		
Total:	151	0.0755
Count:	2	
Total:	1,780,406	890.2030
Count:	711	

Except for 158 tons which were liquid waste and were acceptable for treatment by the Ocean County Utilities Authority's regional wastewater treatment facilities, all of this waste (732 tons) was shipped out of state for disposal. There are no incinerators or alternate technology disposal facilities in the County.

In 1992, there existed a total capacity of approved incineration facilities in the State of 13,719 tons per year. Actual disposal through incineration amounted to 3,774 tons per year (page C-148 of State Plan). Also at that time there were 9,969 permitted capacity tons per year of alternate treatment and destruction facilities. Of this capacity, 2,396 tons per year were utilized. All RMW not treated in these facilities was taken out of state for disposal.

The Department of Environmental Protection projects RMW generation in 1997 to be 21,070 tons for the whole State. Available incineration and alternative technology capacity (as of 1992) was 23,688. This would be enough in totality to accommodate all of the wastes generated in 1997. (That assumes that the capacity of disposal facilities in the State will be utilized even though this would involve difficult regional arrangements among the counties and the generators.)

In the Executive Summary, page 10 of the State Plan Update, the Department of Environmental Protection sets forth its strategy for obtaining self-sufficiency in the disposal of medical waste. It foresees the following:

- \* New commercial disposal facilities. (Until recently these were disallowed.)
- \* Non-commercial facilities. (Incinerators or alternate technology in hospitals or other large facilities.)
- \* More effective use of existing capacity.
- \* Interdistrict agreements. (Actually, these would be arrangements for regional use of facilities that are now under used or are to be installed in the future.)

There have so far been four regional partnerships for medical waste disposal (Executive Summary, page 27 of the State Plan Update) and these were among hospitals that were already affiliated.

None of the RMW generators in Ocean County have advanced a proposal to construct treatment or other disposal facilities. Self-sufficiency could come about through the construction of commercial disposal facilities if and when it appears profitable to do so.

The second possibility which will diligently be pursued, will be utilization of incineration facilities to be expanded and managed by Burlington County or its agent at Fort Dix.

\* \* \*

## **APPENDICES**

- Appendix I.** List of Approved Solid Waste & Recycling Facilities
- Appendix II.** Dover Township Public Works Facility Location Map
- Appendix III.** Dover Township Public Works Facility Agreement
- Appendix IV.** Response Document
- Appendix V.** Resolution of Adoption - Solid Waste Advisory Council
- Appendix VI.** Resolution of Adoption - Board of Chosen Freeholders

## **APPENDIX I**

### **List of Approved Solid Waste & Recycling Facilities**

# APPENDIX I.

## OCEAN COUNTY DISTRICT SOLID WASTE MANAGEMENT PLAN - APPROVED FACILITIES AS OF APRIL 1996

FACILITY NAME	MAILING ADDRESS/ CONTACT-PHONE	MATERIALS ACCEPTED	STREET LOCATION/TWP. BLOCK-LOT	CURRENT STATUS	DATE INCLUDED
ANDREW NEMETH FARM	P.O. Box 55 Cream Ridge, NJ 08514 Andrew Nemeth (609) 758-3130	farm leaf mulching facility	Millstream Rd., Plumsted Twp. Block 58, Lot 13	Inactive	02/19/91
ASSOCIATED HUMANE SOCIETIES, INC. (POPCORN ZOO)	Humane Way (off Lacey Rd.) P.O. Box 43 Forked River, NJ 08731 Lee Bernstein (609) 693-1900	small incinerator on-site for animal carcasses	W. Lacey Rd. Lacey Twp. Block 2811, Lot 2	Operating	06/07/89
BEACHWOOD LEAF COMPOST FACILITY	1600 Pinewald Rd. Beachwood, NJ 08722 Jo Ann Kurilla (908) 286-6010	compost facility for vegetative waste (leaves and light brush)	Hickory St. Boro of Beachwood Block 8.49, Lots 1 and 2, Block 8.64, Lots 1 and 4, Block 8.63, Lots 1,2,3 Block 8.49, Lots 1,2 and Block 8.64, Lots 1 and 4	Operating	10/21/87
BERKELEY LEAF COMPOST FACILITY	P.O. Box B Bayville, NJ 08721 Mark Vanella (908) 349-4616	compost facility for vegetative waste (leaves and light brush)	Pinewald-Keswick Rd. Berkeley Twp. Block 23, Lot 2	Operating	02/19/91
BIL-JIM RECYCLING FACILITY	RD #4, Box 88 Jackson, NJ 08527 James R. Johnson, Jr. (908) 928-1040	asphalt, concrete products, stumps, wood products (non-chemically treated and unpainted wood)	577 South Hope Chapel Rd. Jackson Twp. Block 14.19, 14.15, Lots 1,25	Operating	02/19/91
BRICK LEAF COMPOST FACILITY	401 Chambers Bridge Rd. Brick, NJ 08723 Jack Nydam	compost facility for vegetative waste (leaves and light brush)	Ridge Rd. Brick Twp. Block 1422, Lots 4,20,21 and 25	Operating	10/21/87



# OCEAN COUNTY DISTRICT SOLID WASTE MANAGEMENT PLAN - APPROVED FACILITIES AS OF APRIL 1996

FACILITY NAME	MAILING ADDRESS/ CONTACT-PHONE	MATERIALS ACCEPTED	STREET LOCATION/TWP. BLOCK-LOT	CURRENT STATUS	DATE INCLUDED
BRICK WALL CORPORATION RECYCLING FACILITY	2215 W. Lacey Rd. Forked River, NJ 08731 Charles J. Hesse (609) 693-6300	concrete, brick, block and asphalt	W. Lacey Rd. Lacey Twp. Block 4005, Lot 10	Proposed	*12/06/95
DOVER LEAF COMPOST FACILITY	33 Washington St. Toms River, NJ 08753 Jim Shannon (908) 341-1000	compost facility for vegetative waste (leaves and light brush)	Church Rd. & Bay Ave. Dover Twp. Block 231, Lots 7 and 10	Operating	10/21/87
DOVER LEAF COMPOST FACILITY #2	33 Washington St. Toms River, NJ 08753 Jim Shannon (908) 341-1000	compost facility for vegetative waste (leaves and light brush)	Whitesville Rd., Dover Twp. Block 539, Lot 5	Operating	02/19/91
DOVER SOLID WASTE TRANSFER STATION	33 Washington St. Toms River, NJ 08753 Larry Cagliostro (908) 341-1000	type 10 msw and source separated recyclable materials	Church Rd. & Bay Ave. Dover Twp. Block 231, Lots 7,10,11	Proposed	4/3/96
EARLE ENVIRONMENTAL CORP.	P.O. Box 757 Farmingdale, NJ 07727 Walter Earle, Jr. (908) 657-8551	private recycling facility for ID#27 non-hazardous petroleum contaminated soils	Rt. 547, Jackson Twp. Block 13.01, Lot 1	Operating	*08/6/91
JACKSON LEAF COMPOST FACILITY	R.D. 4, Box 1000 Jackson, NJ 08527 Tim Myers (908) 928-1200	compost facility for vegetative waste (leaves and light brush)	Kierych Dr. (Hulse Rd.), Jackson Twp Block 80, Lot 8.02	Operating	10/21/87

# OCEAN COUNTY DISTRICT SOLID WASTE MANAGEMENT PLAN - APPROVED FACILITIES AS OF APRIL 1996

FACILITY NAME	MAILING ADDRESS/ CONTACT-PHONE	MATERIALS ACCEPTED	STREET LOCATION/TWP.		CURRENT STATUS	DATE INCLUDED
			BLOCK-LOT			
JOHN KUMMINGS STUMP REDUCTION CTR.	55 Cox Avenue West Creek, NJ 08092 John Kummings (609) 296-6968	private recycling facility that processes stumps	Old Country Rd., Eagleswood Twp. Block 34, Lot 1		Proposed	02/19/91
LACEY LEAF COMPOST FACILITY	820 Municipal Lane Forked River, NJ 08731 Mary Egolf (609) 693-1100	compost facility for vegetative waste (leaves and light brush	Municipal Lane, Lacey Twp. Block 1832, p/o Lots 2-7; Block 1834, Lots 17 - 22 and 33 - 38		Operating	10/21/87
LONGVIEW MATERIAL RECOVERY FACILITY (formerly Rosetto's)	CN-2021 Toms River, NJ 08754-2021 Dan Carraccio (908) 341-6100	proposed private facility that will process type 10, 13, 27 waste, and recyclable materials	Rt. 37 West Dover Twp. Block 411, Lot 1.2		Proposed	02/19/91
LONGVIEW RECYCLING CENTER (formerly Rosetto's)	CN-2021 Toms River, NJ 08754-2021 Dan Carraccio (908) 341-6100	private recycling facility that processes wood and asphalt shingles	1301 Rt. 37 West Dover Twp. Block 506-1, Lots 1 thru 7		Operating	06/07/89
MANCHESTER LEAF COMPOST FACILITY	1 Colonial Drive Lakehurst, NJ 08733 Steve Stanviano (908) 657-8121	compost facility for vegetative waste (leaves and light brush)	Rt. 70, Manchester Twp. Block 116, Lot 13		Operating	10/21/87
OCEAN COUNTY LANDFILL, INC.	P.O. Box Drawer #4 Belford, NJ 07718 Charles Hesse (908) 341-6982	private landfill that accepts type 10,13,23, 25,27 waste	Rt. 70, Manchester Twp. Block 2, Lots 1,2,5,6,8,9, 10,11,12,13,14,15,16,17,18, 19,20,21,22,23,24,30,31,32, 33,34,35,36,37,59,60,61,62, 64,65,768,769,770,771,772, 777, and 778; Block 3.02, Lot 642; and Block 33, Lot 783 Block 3, Lots 635,636,637,638, Block 3.03, Lots 1		Operating	1/79

# OCEAN COUNTY DISTRICT SOLID WASTE MANAGEMENT PLAN - APPROVED FACILITIES AS OF APRIL 1996

FACILITY NAME	MAILING ADDRESS/ CONTACT-PHONE	MATERIALS ACCEPTED	STREET LOCATION/TWP. BLOCK-LOT	CURRENT STATUS	DATE INCLUDED
OCEAN COUNTY LANDFILL, INC. SOLID WASTE COMPOST OPERATION	P.O. Box Drawer #4 Belford, NJ 07718 Charles Hesse (908) 341-6982	proposed private facility that will process type 10 waste for compost	Rt. 70, Manchester Twp. Block 2, Lots 31 and 32	Proposed	02/19/91
OCEAN COUNTY LANDFILL, INC./ RUTGERS PILOT COMPOST OPERATION	P.O. Box Drawer #4 Belford, NJ 07718 Charles Hesse (908) 341-6982	proposed field facility that will process type 10 waste for compost	Rt. 70, Manchester Twp.	Proposed	2/19/91
OCEAN COUNTY NORTHERN RECYCLING CENTER	601 New Hampshire Ave. Lakewood, NJ 08701 Art Burns (908) 367-0802	County recycling facility that processes aluminum cans, tin cans, glass containers, newspapers, commercial/ residential cardboard, mixed paper, office paper, plastic beverage containers, other plastic containers; compost facility for vegetative waste (leaves, grass and light brush)	601 New Hampshire Ave. Lakewood Twp. Block 1160.06, Lot 241	Operating	10/21/87
OCEAN COUNTY RECYCLING CENTER, INC.	1497 Lakewood Rd. Toms River, NJ 08755 Louis Sanzaro (908) 244-1716	private recycling facility that processes concrete, asphalt, masonry products, cement blocks, bricks, tree stumps	Rt. 9 Dover Twp. Block 410, Lot 26	Operating	06/07/89

# OCEAN COUNTY DISTRICT SOLID WASTE MANAGEMENT PLAN - APPROVED FACILITIES AS OF APRIL 1996

FACILITY NAME	MAILING ADDRESS/ CONTACT-PHONE	MATERIALS ACCEPTED	STREET LOCATION/TWP. BLOCK-LOT	CURRENT STATUS	DATE INCLUDED
OCEAN COUNTY SOUTHERN RECYCLING CENTER	601 New Hampshire Ave. Lakewood, New Jersey 08701 Art Burns (908) 367-0802	County recycling transfer station facility that collects aluminum cans, tin cans, glass containers, newspapers, commercial/residential cardboard, mixed paper, office paper, plastic beverage containers, and other plastic containers for processing at Northern facility; compost facility for vegetative waste (leaves and light brush)	Recovery & Hay Rd. Stafford Twp. Block 25, Lot 59	Operating	10/21/87
PINELANDS RECYCLING, INC.	782 Route 9 Bayville, NJ 08721 Dean Mabie (908) 269-5200	vegetative materials, including stumps, brush and tree parts, concrete and masonry products, unpainted wood and asphalt	Stafford Twp. Industrial Park Stafford Twp. Block 25, Lots 79,81,85,86	Proposed	*01/17/96
RALPH CLAYTON & SONS	515 Lakewood-New Egypt Rd. Lakewood, NJ 08701 Douglas Clayton (908) 363-1995	private recycling facility that processes concrete, asphalt, brick and block	515 Lakewood-New Egypt Rd. Lakewood Twp. Block 11.5, Lot 70	Operating	06/07/89
ROBERT GOFF FARM	133 W. Colliers Mills Rd. New Egypt, NJ 08533 Robert Goff (609) 758-7370	farm leaf mulching facility	Magnolia Ave., Plumsted Twp. Block 10, Lot 61 Q	Operating	*08/06/91

# OCEAN COUNTY DISTRICT SOLID WASTE MANAGEMENT PLAN - APPROVED FACILITIES AS OF APRIL 1996

FACILITY NAME	MAILING ADDRESS/ CONTACT-PHONE	MATERIALS ACCEPTED	STREET LOCATION/TWP. BLOCK-LOT	CURRENT STATUS	DATE INCLUDED
SOUTH BRUNSWICK ASPHALT	Mizzen & R.R. Avenue Box 352 Beachwood, NJ 08722 Eugene Johnson Jim Lowery (908) 269-3105	private recycling facility that processes stumps, trees, concrete and asphalt	Mizzen & R.R. Ave. Berkeley Twp. Block 824, Lot 1	Operating	06/07/89
SOUTH JERSEY RECYCLING CENTER	P.O. Box 31 Berlin, NJ 08009 Ed Stella, Jr. (609) 768-1510	private recycling facility that processes stumps, tree trunks and limbs for wood chips	Whiting-Hornerstown Rd. Plumsted Twp. Block 79, Lot 28	Proposed	11/19/91
STAFFORD LEAF COMPOST FACILITY	775 East Bay Avenue Manahawkin, NJ 08050 Ron Cop (609) 978-0239	compost facility for vegetative waste (leaves and light brush)	Hay Rd., Stafford Twp. Block 25, Lots 13,14, and 15	Operating	10/21/87
TANNER LANDFILL (STUMP DUMP)	691 E. Bay Ave., Barnegat, NJ 08005, Francis Tanner, Jr. (609) 698-2188	private landfill for vegetative waste, and stumps	Gunning River Rd. Barnegat Twp. Block 114, Lot 13;Block 174, Lots 13,37,47 and 47.01	Operating	1/79
TOMS RIVER REGIONAL SCHOOL DISTRICT	Toms River H.S. North Old Freehold Rd. Toms River, NJ 08753 Raymond Ryan (908) 341-9200	small incinerator on-site for confidential student files and non-toxic school nurse waste	Toms River H.S. North Old Freehold Rd. Dover Twp. Block 410-C, Lot 30	Operating	06/07/89

\* - Expedited process

## **APPENDIX II**

### **Dover Township Public Works Facility Location Map**

# Appendix II

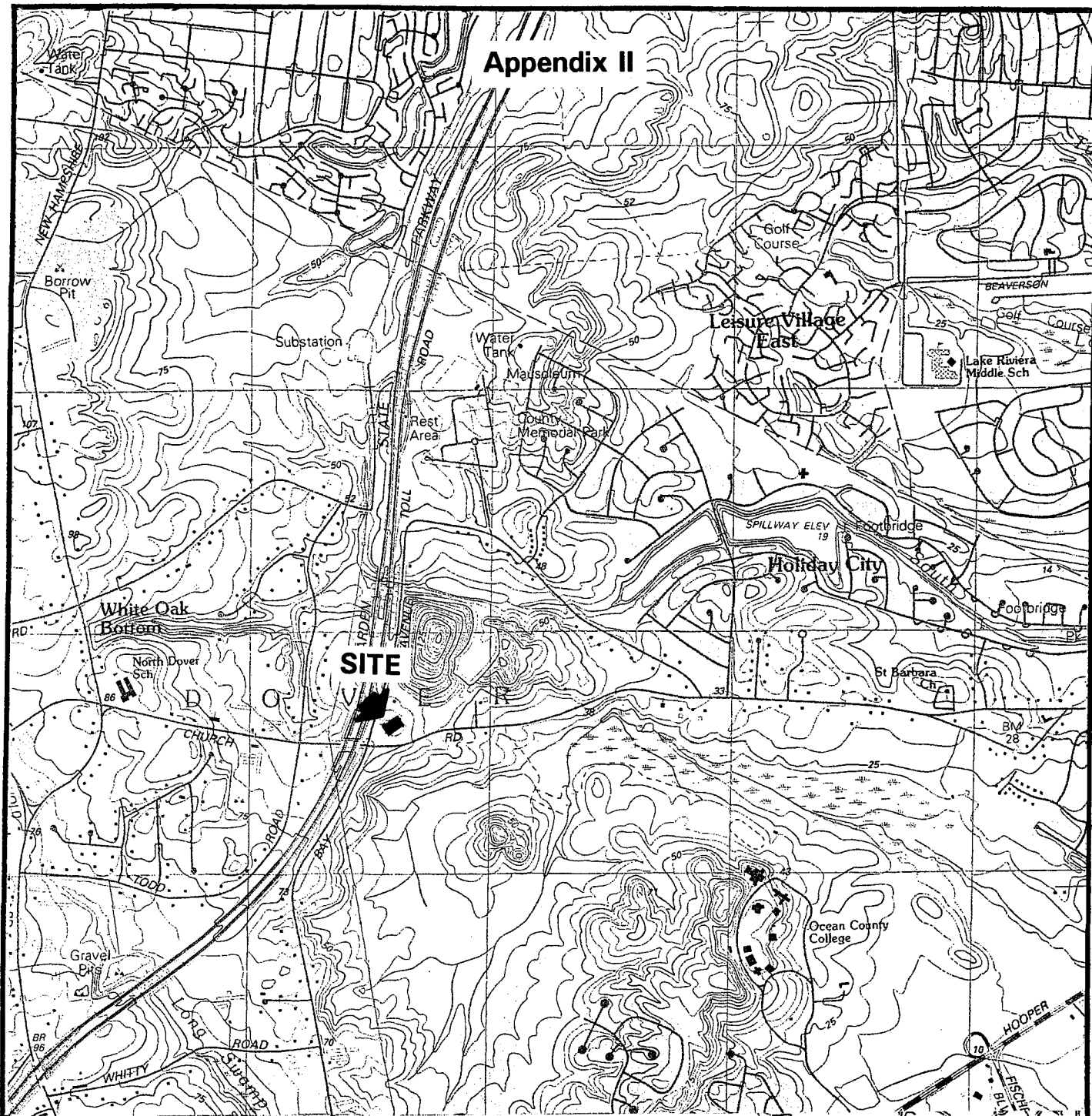

## Key Map Ocean County

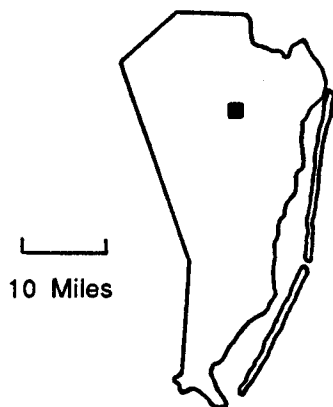

## Dover Township Transfer Station

Ocean County, NJ

1000 0 1000 2000 3000 4000 5000 6000  
FEET

Scale: 1" = 2,000'  
Source: U.S.G.S.

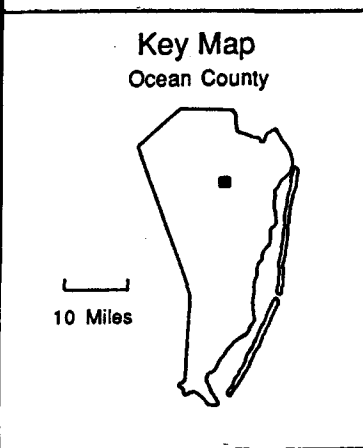
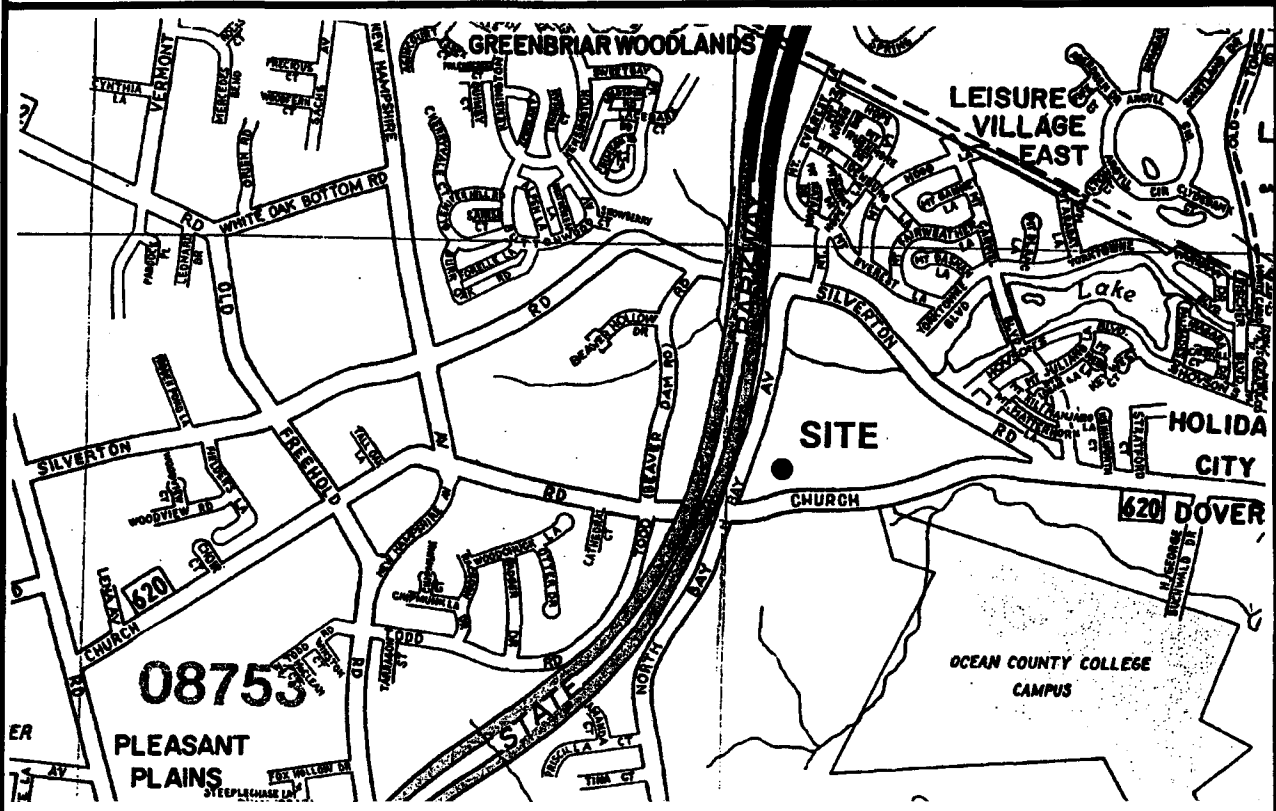
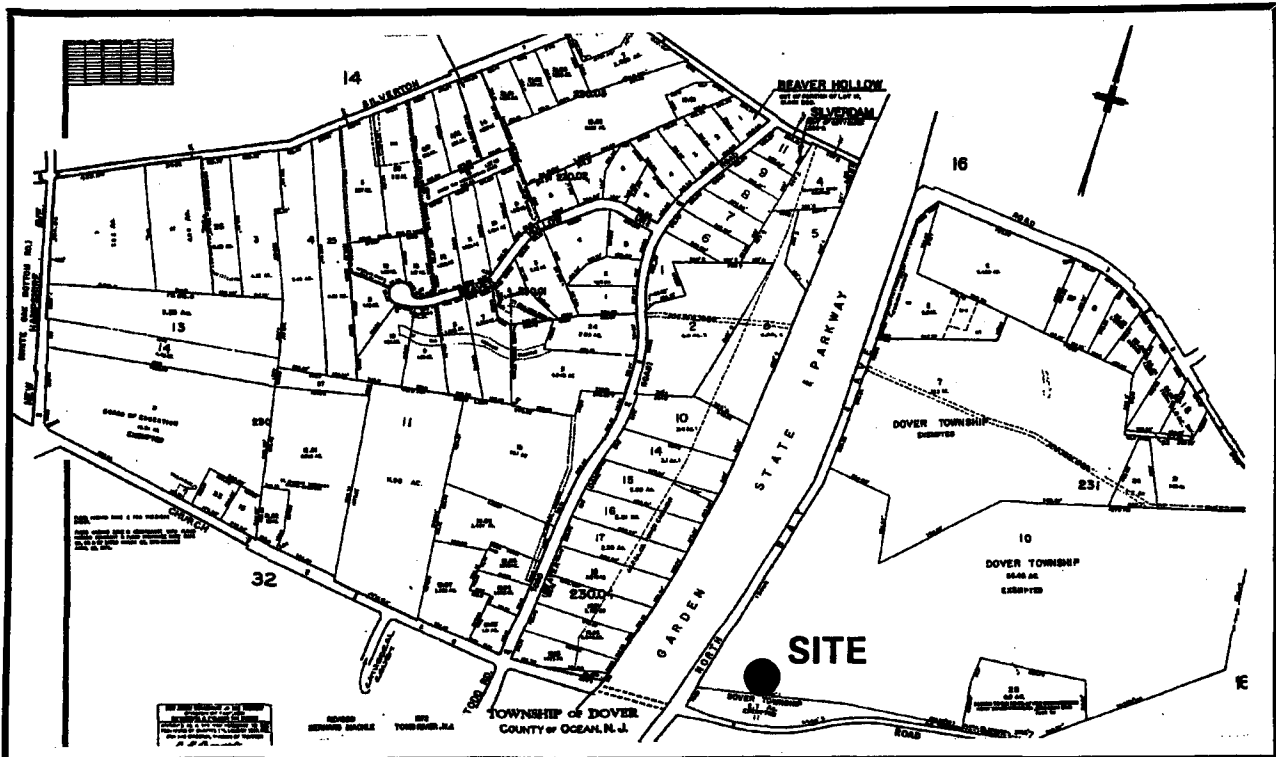

**Dover Township Public Works Facility  
Transfer Station**  
**Ocean County, NJ**



### **APPENDIX III**

#### **Dover Township Public Works Facility Agreement**

**APPENDIX III**

**AGREEMENT BETWEEN  
OCEAN COUNTY BOARD OF CHOSEN FREEHOLDERS**

**AND**

**TOWNSHIP OF DOVER  
PROVIDING FOR INCLUSION OF A PROPOSED  
250 TON PER DAY SOLID WASTE TRANSFER STATION  
IN THE OCEAN COUNTY SOLID WASTE MANAGEMENT PLAN**

**DATED: April 3, 1996**

## Table of contents

SECTION 1.	<u>Definitions</u>	4
SECTION 2.	<u>Delivery of Acceptable Waste and Recyclable Materials at the Facility.</u>	8
SECTION 3.	<u>Design Capacity.</u>	9
SECTION 4.	<u>Solid Waste Disposal.</u>	9
SECTION 5.	<u>Disposition of Recyclable Materials.</u>	9
SECTION 6.	<u>Prohibited Wastes and Materials.</u>	10
SECTION 7.	<u>Construction, Operation and Maintenance of Facility.</u>	10
SECTION 8.	<u>Commencement and Term.</u>	11
SECTION 9.	<u>Inclusion of Facility in County Plan.</u>	11
SECTION 10.	<u>Staffing and Training.</u>	13
SECTION 11.	<u>Facility Performance Review and Inspection.</u>	13
SECTION 12.	<u>Compliance with the Law.</u>	13
SECTION 13.	<u>Screening of Solid Waste Stream.</u>	14
SECTION 14.	<u>Applicable Law.</u>	14
SECTION 17.	<u>Termination of Agreement</u>	15
SECTION 18.	<u>Remedies Upon Township Default.</u>	17
SECTION 19.	<u>Expense of Enforcement of Covenants.</u>	18
SECTION 21.	<u>Township's Ability to Contract.</u>	18
SECTION 22.	<u>Environmental Compliance.</u>	19
SECTION 23.	<u>Notice of Violations.</u>	20
SECTION 24.	<u>Notice.</u>	20
SECTION 25.	<u>Waiver.</u>	21
SECTION 26.	<u>Severability</u>	21
SECTION 27.	<u>Entire and Complete Agreement.</u>	21
SECTION 28.	<u>Binding Effect.</u>	22

SECTION 29. <u>Other Documents.</u>	22
SECTION 30. <u>Relationship of the Parties.</u>	22
SECTION 31. <u>Headings.</u>	22
SECTION 32. <u>Assignment.</u>	22

AGREEMENT BETWEEN OCEAN COUNTY BOARD OF  
CHOSEN FREEHOLDERS AND THE TOWNSHIP OF DOVER  
PROVIDING FOR INCLUSION OF PROPOSED 250 TON  
PER DAY A SOLID WASTE TRANSFER STATION IN THE  
COUNTY SOLID WASTE MANAGEMENT PLAN

THIS AGREEMENT, made and entered into this 3rd day of April, 1996, by and between the OCEAN COUNTY BOARD OF CHOSEN FREEHOLDERS, hereinafter called "County", with offices at the Ocean County Administration Building, Hooper Avenue, Toms River, New Jersey 08753 and THE TOWNSHIP OF DOVER, hereinafter called "Township", with offices at Dover Township Municipal Building, Washington Street, Toms River, New Jersey 08753.

WHEREAS, the County is charged with the obligation of preparing and adopting a Solid Waste Management Plan for the Ocean County Solid Waste District pursuant to the provisions of the New Jersey Solid Waste Management Act, N.J.S. 13:1E-1 et seq.; and

WHEREAS, the County is likewise charged with the obligation of preparing and adopting a Recycling Plan for the Ocean County Solid Waste District pursuant to the provisions of the Statewide Mandatory Source Separation and Recycling Act, N.J.S. 13:1E-99.11 et seq.; and

WHEREAS, the County has adopted and the State Department of Environmental Protection has certified and approved the Ocean County District Solid Waste Management Plan and the Ocean County Recycling Plan; and

WHEREAS, Township has applied to the County for inclusion in the Ocean County Plan of a 250 ton per day Type 10 Municipal Solid Waste Transfer Station to be designed, constructed and operated by the Township at Tax Lots 7, 10 and 11, Block 231, Dover Township, Ocean County, New Jersey; and

WHEREAS, the Facility proposed by Township will be capable of receiving up to a total of 250 tons per day of Type 10 Municipal Solid Waste to be transported and delivered for disposal at the OCLF sanitary landfill facility, Manchester Township, New Jersey; and

WHEREAS, the Township recognizes and acknowledges the comprehensive approach contained in the County Plan and implemented by the County for the collection and disposal of Solid Waste and the processing and marketing of source separated recyclable materials; and

WHEREAS, the Township further recognizes that on August 31, 1994, the New Jersey Department of Environmental Protection awarded the OCLF a Solid Waste Disposal Franchise pursuant to N.J.S.A. 48:13A-1 et seq., designating the OLCF Sanitary Landfill, Manchester Township, Ocean County, New Jersey as the Disposal Facility for all Solid Waste types 10, 13, 23, 25 and 27 Generated within Ocean County, including the Township of Dover; and

WHEREAS, the Township agrees to cooperate with the County in the implementation of the County Plan by assuring that all Solid Waste collected by

the Township and delivered to the proposed Facility shall thereafter be transported to and disposed of at the OCLF sanitary landfill facility in Manchester Township consistent with the County Plan and OCLF's Franchise; and

WHEREAS, the Facility proposed by Township, subject to Township's compliance with the terms and conditions of this Agreement, is consistent with the County Plan as well as the Franchise awarded to OCLF; and

WHEREAS, the County has agreed to propose an amendment to the County Plan to include the Township's proposed Facility therein upon Township's acceptance of the terms and conditions set forth in this Agreement; and

WHEREAS, the Township desires to enter into this Agreement with the County, acknowledging Township's acceptance of the terms and conditions set forth herein; and

WHEREAS, the inclusion of the Township's Facility within the County Plan is specifically conditioned and contingent upon Township's application for and receipt of a Solid Waste Facility Permit from the NJDEP and all Required Approvals necessary for the construction and operation of the proposed Facility and the incorporation of Township's compliance with this Agreement as a term and condition of Township's Solid Waste Facility Permit.

NOW, THEREFORE, in consideration of the mutual promises contained herein, the County and the Township agree as follows:

SECTION 1. Definitions. For the purposes of this Agreement, the following terms shall have the following meanings:

"Accept" or "Acceptance" means the receipt of and taking responsibility by the Township of Acceptable Waste and Designated Recyclable Materials at the Facility in accordance with the terms and conditions of this Agreement.

"Acceptable Waste" means Type 10 Municipal Solid Waste as defined in N.J.A.C. 7:26-2.13(g) which is collected by the Township or on behalf of the Township from its residents and transported to the Facility in the collection vehicles.

"Agreement" means this Agreement between the County and the Township, providing for the inclusion of the Township's Facility in the County Plan.

"County" means the Ocean County Board of Chosen Freeholders and/or the County of Ocean, as the context requires.

"County Plan" means:

1. The Ocean County District Solid Waste Management Plan adopted by the Ocean County Board of Chosen Freeholders on July 18, 1979 and approved by the NJDEP on July 31, 1980, and all subsequent amendments thereto; and

2. The Ocean County Recycling Plan adopted by the Ocean



County Board of Chosen Freeholders as an element of the Ocean County District Solid Waste Management Plan on October 21, 1987, and approved by the NJDEP on March 22, 1988, and all subsequent amendments thereto.

"Designated Recyclable Materials" means that list of Source Separated Recyclable Materials set forth on Schedule B of this Agreement which are collected by the Township or on behalf of the Township from its residents and transported to the Facility in collection vehicles.

"Director" means the Director of the Ocean County Department of Solid Waste Management.

"Disposal" means the storage, treatment, utilization, processing or final disposition of Solid Waste.

"Facility" means the Type 10 Municipal Solid Waste and Source Separated Recyclable Materials Transfer Station to be located at Tax Block 231, Lots 7, 10 and 11, Dover Township, Ocean County, New Jersey, and constructed in accordance with Township's plans and design which are more specifically described on Schedule A hereto, and which are incorporated herein and made a part of this Agreement.

"Facility Site" means Tax Block 231 , Lot 7, 10 and 11, as shown on the current Tax Map of the Township of Dover, Ocean County, New Jersey.

"Franchise" means the exclusive right to control and provide for the

disposal of Solid Waste within a solid waste district or districts awarded by the NJDEP pursuant to the Solid Waste Utility Control Act, N.J.S. 48:13A-1 et seq.

"Generate" means the act or process of producing Solid Waste.

"Generator" means any and all Persons that produce Solid Waste.

"Law" means any federal, state, county, local, administrative or other governmental law, including any statute, ordinance, code or other legislation, regulation, rule or other promulgation or pronouncement, or any judicial, executive or administrative ruling, order or decision.

"NJDEP" means the New Jersey State Department of Environmental Protection.

"Ocean County Health Department" means the Ocean County Health Department established by the Ocean County Board of Health pursuant to N.J.S.A. 26:3A2-1 et seq.

"OCLF" means Ocean County Landfill Corp., Inc., the owner and operator of the Ocean County Landfill sanitary landfill, facility number 1518, Manchester Township, Ocean County, New Jersey.

"Person" means any individual, corporation, partnership, joint venture, association, joint stock company, trust, unincorporated organization or other non-governmental agency or entity or any governmental agency or political subdivision thereof, including any agency or entity created or existing under the

laws of the United States, the State of New Jersey, or any other state, or any combination thereof.

"Recyclable Materials" means those materials which would otherwise become Solid Waste and which may be collected, separated, or Processed and returned to the economic mainstream in the form of raw materials or products.

"Required Approvals" means, with respect to the Facility and this Agreement, the County's adoption of an amendment to the County Plan and its approval by the Commissioner of the NJDEP as set forth in Section 9 of this Agreement; Township's receipt of a Solid Waste Facility Permit from the NJDEP, and all other permits and approvals required to be issued for the Facility as a precondition to the construction and operation of the Facility by any federal, State, County or municipal agency having jurisdiction over the same.

"Solid Waste" or "Waste" means garbage, refuse and other discarded materials resulting from industrial, commercial and agricultural operations, and from domestic and community activities and shall include all other waste materials including liquids.

"Solid Waste Facility" means any system, site, equipment, building or structure which is utilized for the storage, collection, processing, transfer, transportation, separation, recycling, recovering or disposal of Solid Waste other than a "Recycling Center" as defined in N.J.A.C. 7:26-1.4.

"Solid Waste Facility Permit" means a certificate of approved registration and engineering design approval issued by the NJDEP for Township's Facility in accordance with N.J.A.C. 7:26-1.1 et seq.

"Source Separated" means the process of separating Recyclable Materials from the Solid Waste stream by the Generator at the point of Generation.

"Township" means the Township of Dover and the governing body of the Township of Dover, Ocean County, New Jersey.

"Transfer Station" means a Solid Waste Facility at which Waste is transferred from a Solid Waste collection vehicle to a Solid Waste haulage vehicle for transportation to a Solid Waste Facility for Disposal.

"Unacceptable Waste" means any Solid Waste or other materials or substances not specifically allowed to be Accepted by the Township at its Facility under this Agreement, or which would, if Accepted at the Facility, constitute an endangerment to health or safety or give rise to violations of permit conditions for the Facility.

SECTION 2. Delivery of Acceptable Waste and Recyclable Materials at the Facility. The Township shall Accept at the Facility only Source Separated Recyclable Materials and Acceptable Waste collected by Township or on behalf of the Township from its residents and transported to the Facility in collection vehicles. Township shall not Accept or store Acceptable Waste at the Facility, except

within the confines of a completely enclosed building.

SECTION 3. Design Capacity. The design and operating capacity of the Facility shall not exceed a total of 250 tons per day of Acceptable Waste and Source Separated Recyclable Materials combined. The Facility shall be designed, constructed and operated in accordance with Township's design plans more specifically described in Schedule A this Agreement. The Township shall supply the Director with copies of all plans, documents and correspondence between Township and the NJDEP pertaining to the registration, design and permitting of the Facility.

SECTION 4. Solid Waste Disposal. The Township shall be responsible for the Disposal of all Solid Waste Accepted at the Facility at the OCLF Sanitary Landfill Facility, Manchester Township, New Jersey, or at such other Solid Waste Facility as may otherwise be authorized by the County Plan, consistent with applicable law and OCLF's Franchise. The Township's Disposal of Solid Waste other than as specifically authorized by the County Plan, consistent with all applicable law and OCLF's Franchise is prohibited and shall constitute a material breach of this Agreement.

SECTION 5. Disposition of Recyclable Materials.

A. All Designated Recyclable Materials Accepted at the Facility shall be transported by the Township to the Ocean County Recycling Center, New

Hampshire Road, Lakewood Township, New Jersey in accordance with the provisions of the Recycling Center Use and Revenue Sharing Agreement executed by the Township and the County, effective January 1, 1995.

B. The Township shall coordinate the scheduling of deliveries of Designated Recyclable Materials with the Director in order to facilitate the operation of the County's Recycling Center and to minimize congestion and wait time.

SECTION 6. Prohibited Wastes and Materials. The Township shall not knowingly Accept at the Facility any Solid Waste or other materials which is not specifically included within the definition of Acceptable Waste or Source Separated Recyclable Materials. Further, the Township shall not Accept at the Facility any Acceptable Waste or Source Separated Recyclable Materials in excess of the Facility's design capacity of 250 tons per day as set forth in Section 3 of this Agreement.

SECTION 7. Construction, Operation and Maintenance of Facility.

A. In no event shall Township commence operation of the Facility prior to the County's adoption and the NJDEP Commissioner's approval of an Amendment to the County Plan providing for the inclusion of Township's Facility therein in accordance with N.J.S. 13:1E-23 and 24 and Township's receipt of all Required Approvals.

B. Township, upon receipt of all Required Approvals, shall construct, maintain and operate the Facility in accordance with applicable Law, the County Plan and all Required Approvals. Township shall be the exclusive owner and operator of the Facility and nothing herein shall be deemed to make Township an agent, representative or independent contractor of the County.

SECTION 8. Commencement and Term. This Agreement shall be effective and shall commence upon full execution of the Agreement by the Township and the County. This Agreement shall remain in full force and effect for the term of Township's Solid Waste Facility Permit and any renewal thereof consistent with the terms of this Agreement unless sooner terminated by the County in accordance with Sections 9 or 17 of this Agreement.

SECTION 9. Inclusion of Facility in County Plan.

A. Upon the execution of this Agreement by the Township, the County will expeditiously propose an amendment to the County Plan providing for the inclusion of Township's Facility therein in accordance N.J.S. 13:1E-1 et seq. Said amendment to the County Plan shall be subject to the public hearing, comment and approval process set forth in N.J.S. 13:1E-23. Upon the adoption of said amendment by the County and the approval thereof by the Commissioner of the NJDEP in accordance with N.J.S. 13:1E-23 and 24, Township's Facility shall be included in the County Plan.

B. The inclusion of Township's Facility in the County Plan shall be conditioned and contingent upon the following:

(i) The County's adoption of an amendment to the County Plan including Township's Facility therein and the approval of said amendment by the Commissioner of the NJDEP in accordance with the provisions of N.J.S. 13:1E-23 and 24;

(ii) Township's receipt of all Required Approvals; and

(iii) The NJDEP's incorporation of Township's compliance with this Agreement as a term and condition of Township's Solid Waste Facility Permit for the Facility.

C. In the event that each and every condition set forth in subparagraph B of this Section shall not be fully and completely satisfied within two (2) years after the effective date of this Agreement and provided the County has expeditiously proposed an amendment to the County Plan, as set forth in subparagraph A of this Section, then the County shall have the right, at its sole option and discretion, to terminate this Agreement by giving Township thirty (30) days advance written notice of the termination date and the parties shall have no further liability or obligation to each other hereunder.

D. Upon the termination of this Agreement as set forth in subparagraph C of this Section, Township's Facility shall not be included in the



County Plan and shall be deemed inconsistent with the County Plan.

SECTION 10. Staffing and Training. The Township shall insure that a sufficient number of trained and qualified personnel are employed and assigned to operate and maintain the Facility at all times in accordance with all applicable Law, permit and license requirements.

SECTION 11. Facility Performance Review and Inspection. The County, the Ocean County Health Department and their designated representatives, agents and employees may enter the Facility Site and the Facility at any time, review records of Facility performance and inspect the Facility to determine Township's compliance with the Facility's approved Solid Waste Facility Permit, registration statement and engineering design, and with the terms and conditions of this Agreement and all applicable Law, permits and licenses.

SECTION 12. Compliance with the Law.

A. The Township shall comply with all applicable Law, license and permit requirements concerning the collection, storage, transfer, handling and disposal of Solid Waste.

B. The Township shall comply with all applicable requirements of the County Plan.

C. The Township shall adhere to all applicable Law governing the safety and working conditions of its employees.

D. Township warrants and represents that it shall operate the Facility in accordance with the terms and conditions of all Required Approvals and in accordance with all applicable Law and the County Plan. Any violation of the provisions of Section 3 of this Agreement shall constitute a material breach of this Agreement.

SECTION 13. Screening of Solid Waste Stream.

A. The Township shall prohibit the delivery and Acceptance of Unacceptable Waste and all materials other than Acceptable Waste and Source Separated Recyclable Materials at the Facility. The Township shall reject deliveries to the Facility of any Unacceptable Waste or materials.

B. The Township shall perform Solid Waste screening procedures to avoid Accepting Unacceptable Waste, including all materials other than Acceptable Waste and Source Separated Recyclable Materials at the Facility. The Township shall be solely responsible for the removal, transportation and Disposal of all Unacceptable Waste Accepted at the Facility in accordance with the County Plan and OCLF's Franchise and all applicable Law.

SECTION 14. Applicable Law. This Agreement shall be construed and interpreted in accordance with the laws of the State of New Jersey pertaining to contracts executed and to be performed in New Jersey.

SECTION 15. Modification or Amendment. No modification or amendment

to this Agreement and no waiver of any of the provisions or conditions of this Agreement shall be valid unless in writing and signed by an officer or other duly authorized representative of the County and the Township.

SECTION 16. Indemnification.

A. The Township shall defend, indemnify, and hold harmless the County, its officers, employees, representatives and agents, from any and all claims, liabilities, demands, damages or costs of any nature whatsoever arising out of or in any way pertaining to this Agreement, the inclusion of Township's Facility in the County Plan and/or the acts or omissions of the Township or other Persons pursuant to or connected with this Agreement, excluding only such Claims caused or resulting solely through the intentional, willful or negligent acts of the County, its employees and agents.

B. The indemnification of the County, its officers, employees, representatives and agents hereunder shall include all reasonable costs, including legal fees, disbursements and expert fees incurred in defending any lawsuit or administrative proceeding brought against the County, its officers, employees and agents.

SECTION 17. Termination of Agreement.

A. Termination by the County. The County may terminate this Contract for an Event of Default by the Township in accordance with subsection

B of this Section 17.

B. Events of Default by Township. Each of the following shall independently constitute an Event of Default by the Township:

(I) Township's knowing Acceptance of Unacceptable Waste at the Facility.

(ii) Township's knowing Acceptance of any Prohibited Wastes or Materials at the Facility in violation of Section 6 of this Agreement.

(iii) Township's Disposal of Solid Waste at a Solid Waste Facility or other site not designated in the County Plan consistent with all applicable law and OCLF's Franchise.

(iv) The failure of the Township to perform any of its other obligations in accordance with the terms of this Agreement, provided, however, that no such failure shall constitute an Event of Default by the Township unless and until the Director has given notice to the Township specifying that a particular fault or faults exist and the Township has not corrected the fault(s) within thirty (30) days from the date of the notice.

C. Termination for Events of Default.

(I) The County, upon electing to terminate this Contract for an Event of Default, shall direct the Director to give the Township notice of the termination date, which shall be not less than ten (10) days nor more than thirty (30)

days from the date the notice is given. Termination for an Event of Default shall not affect any of Township's liabilities or obligations hereunder through the date of termination.

(ii) If the County terminates this Agreement for an Event of Default by the Township, Township shall cease and discontinue operation of its Facility on the termination date set forth in the notice of termination and shall not thereafter operate its Facility without the express written consent of the County, which consent the County may grant or withhold on such terms and conditions as the County, in its sole discretion, deems appropriate and just.

#### SECTION 18. Remedies Upon Township Default.

A. If the Township commits an Event of Default as specified in Section 17 of this Agreement or threatens to commit an Event of Default, the County in addition to any and all other rights and remedies it may have, shall have the right and remedy, without posting bond or other security, to have each and every provision of this Agreement specifically enforced by the Ocean County Superior Court, Chancery Division, it being acknowledged and agreed that any such Event of Default or threatened Event of Default will cause irreparable injury to the County, and the residents thereof, and that money damages will not provide an adequate remedy at law.

B. Each of the County's rights and remedies enumerated in this

Agreement shall survive the termination of this Agreement, shall be independent of the other, and shall be severally enforceable, and all of such rights and remedies shall be in addition to, and not in lieu of, any other rights and remedies available to County at law or in equity.

SECTION 19. Expense of Enforcement of Covenants. In the event that any administrative proceeding or suit at law or in equity is brought by the County to enforce the terms and conditions of this Agreement or to obtain money damages for an Event of Default by Township, the County, upon prevailing in any such action, suit or administrative proceeding shall be entitled to reimbursement from the Township for all expenses (including, without limitation, reasonable attorneys' fees and disbursements) incurred in connection therewith. The provisions of this Section 19 shall survive the termination of this Agreement.

SECTION 20. Unenforceable Terms and Conditions. If any of the terms and conditions of this Agreement are hereafter construed to be invalid or unenforceable, the same shall not affect the remainder of the terms and conditions of this Agreement which shall be given full effect, without regard to the invalid portions.

SECTION 21. Township's Ability to Contract. Township warrants and represents that it may legally enter into this Agreement; that it intends all terms and conditions contained in this Agreement to be legally binding on Township; and that

all terms and conditions contained in this Agreement are valid and legally enforceable against Township.

SECTION 22. Environmental Compliance. The Township shall comply with all applicable environmental Law, license and permit requirements, including, but not limited to all applicable standards, orders, requirements and regulations adopted under the following:

- A. The Clean Air Act, 42 U.S.C. §7401 et seq.;
- B. The Clean Water Act, 33 U.S.C. §1251 et seq.;
- C. The Resource Conservation and Recovery Act (RCRA),  
42 U.S.C. §6901 et seq.;
- D. The Air Pollution Control Act, N.J.S. 26:2C-1 et  
seq.;
- E. The Noise Control Act of 1971, N.J.S. 13:1G-1 et  
seq.;
- F. The Soil Erosion & Sediment Control Act, N.J.S.  
4:24-39 et seq.;
- G. The New Jersey Solid Waste Management Act, N.J.S.  
13:1E-1 et seq.;
- H. The Statewide Mandatory Source Separation and  
Recycling Act, N.J.S. 13:1E-99.11 et seq.; and
- I. The Water Pollution Control Act, N.J.S. 58:10A-1  
et seq.

If Township fails to comply with the provisions of this Section, Township shall pay all fines, deficiencies, penalties, levies or other sanctions which may be

levied against the Township for any such failure and the Township shall immediately make, at the Township's sole cost and expense, any changes, modifications, or additions to the Facility as may be necessary to bring the Facility into compliance with all applicable environmental Law, license and permit requirements.

SECTION 23. Notice of Violations.

A. Township shall immediately notify the Director in writing of any change in the status of any license, permit, authorization or approval required by Township for the performance of his obligations and duties hereunder.

B. Township shall immediately notify the Director in writing in the event that the Township receives any communication from the USEPA, NJDEP or any other governmental body or agency indicating that Township's Facility is alleged or considered to be in violation of any Law, permit condition or approval, or is being considered for or subject to an enforcement action by any federal, state or local government body or agency.

SECTION 24. Notice. Any notice or other communications required or permitted hereunder shall be in writing and will be deemed sufficiently given only if delivered in person or sent by telegram or by first-class mail, postage prepaid, and addressed as follows:

(a) The County at: Ocean County Board of Chosen Freeholders  
Administration Building  
CN 2191  
Toms River, NJ 08754



Attn: Director, Department of  
Solid Waste Management

(b) The Township at: Dover Township Municipal Building  
33 Washington Street  
Toms River, NJ 08753  
Attn: Township Administrator

Changes in the respective addresses to which such notices may be directed may be made from time to time by either party by written notice to the other party.

SECTION 25. Waiver. The waiver by the County of any default, breach or violation of the provisions of this Agreement shall not operate or be construed as a waiver of any other default, breach or violation of the provisions of this Agreement.

SECTION 26. Severability. If any provision of this Agreement is found to be invalid by any court, administrative agency or tribunal of competent jurisdiction, the invalidity of any such provision shall not effect the validity of the remaining provisions hereof.

SECTION 27. Entire and Complete Agreement. This Agreement constitutes the entire and complete agreement of the parties pertaining to the inclusion of Township's Facility in the County Plan. This Agreement supersedes all prior or contemporaneous representations, understandings, arrangements and commitments, all of such, whether oral or written, having been merged herein.

SECTION 28. Binding Effect. This Agreement has been duly entered into and constitutes a legal, valid and binding obligation of the Township enforceable in accordance with its terms and it shall inure to the benefit of the parties hereto and any successor or assignee acquiring an interest hereunder.

SECTION 29. Other Documents. The Township agrees to execute and deliver any instruments and to perform any acts that may be necessary or reasonably requested in order to give full effect to this Agreement.

SECTION 30. Relationship of the Parties. No party to this Agreement shall have any responsibility whatsoever to perform services or to assume contractual obligations that are the obligations of the other party. Nothing herein shall constitute either party a partner, employee, agent or representative of the other party, or create any fiduciary relationship between the parties.

SECTION 31. Headings. Captions and headings in this Agreement are for reference only and do not constitute a part of this Agreement.

SECTION 32. Assignment. This Agreement shall not be assigned by the Township without the prior written consent of the County. In any event, and notwithstanding any consent given by the County, no purported assignment by the Township shall be valid or effective, and no assignment by the Township shall relieve the Township of any of its obligations under this Agreement, unless and until the Township guarantees the performance of the assignee. Any prohibited

assignment of this Agreement shall be null and void.

IN WITNESS WHEREOF, the parties have executed this Agreement as of the  
date first above written.

ATTEST:

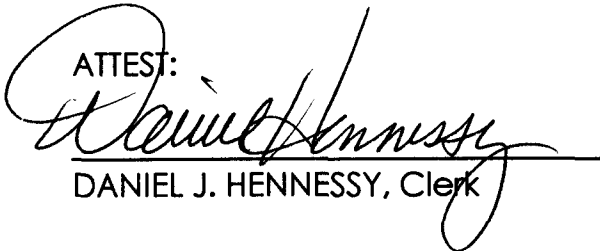
  
DANIEL J. HENNESSY, Clerk

ATTEST:

  
Vincent M. Miroletta, Deputy Clerk

BOARD OF CHOSEN FREEHOLDERS,  
OCEAN COUNTY

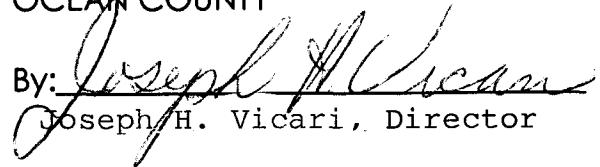
By:   
Joseph H. Vicari, Director

TOWNSHIP OF DOVER

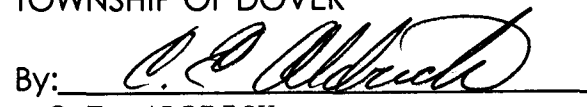
By:   
C.E. ALDRICH  
MAYOR

## SCHEDULE A

Plans entitled "1995 Dover Township Public Works Transfer Station - Dover Township Public Works Complex, Church Road and Bay Avenue, Toms River, New Jersey," prepared by Yezzi Associates, Architects & Planners, consisting of six drawings as follows:

1. L-1 Location Map, dated March 22, 1995;
1. AP-1 Site Plan, dated September 12, 1994, last revised March 17, 1995;
3. AP-2 Topographic Information Map, dated September 14, 1994, last revised March 24, 1995;
4. AP-3 Topographic Information Map, dated September 14, 1994, last revised March 24, 1995;
5. AP-4 Preliminary Floor Plan, dated September 12, 1994, last revised March 24, 1995; and
6. AP-5 Elevations, dated September 12, 1994, last revised March 24, 1995.

## **SCHEDULE B**

### **Designated Recyclable Materials**

A. **Commingled Recyclables** - consisting of green, brown and clear glass, aluminum cans (aluminum top with steel sides and bottom), all plastic bottles and empty steel aerosol cans.

B. **Paper Stream** - these materials are collected as three separate items and cannot be combined.

1. **Newsprint** - all the newsprint plus inserts that come with your daily newspaper, bundled and tied with a string.
2. **Mixed Paper** - magazines, catalogues, junk mail and used writing paper (all colors) placed inside a brown bag.
3. **Corrugated** - brown corrugated cardboard broken and flattened into a tight bundle and tied with a string.

**APPENDIX IV**  
**Response Document**

**APPENDIX IV**

**RESPONSE**

**to**

**Questions and Comments Offered for the Record of the April 3, 1996  
Public Hearing on a  
Proposed Amendment to the Ocean County Solid Waste Management Plan**

**April 12, 1996**

**Prepared for:**

**Ocean County Board of Chosen Freeholders**

**Toms River, New Jersey**

RESPONSE  
to  
Questions and Comments Offered for the Record of the April 3, 1996  
Public Hearing on a  
Proposed Amendment to the Ocean County Solid Waste Management Plan

RESPONSE DOCUMENT

The Ocean County Board of Chosen Freeholders on April 3, 1996, held a public hearing to receive comment on a proposed amendment to the Ocean County District Solid Waste Management Plan. No one offered testimony at the hearing. Five written communications were received.

At the request of the Freeholders, staff and advisors have prepared summaries of these statements and responses. A copy of the Response Document will be sent by the Board to those persons who submitted statements.

**1. Comments on the List of Approved Facilities (Appendix I)**

Q. Associated Humane Societies Incorporated requested that medical waste be removed from the list of materials accepted.

A. The requested change has been made.

Q. Robert Goff Farm asked that its address be changed to 133 West Colliers Mills Road, New Egypt, NJ 08533.

A. The requested change has been made.

Q. Toms River Veterinary Hospital stated that its incinerator has been shut down since 1989 and asks that it be taken off the list.

A. The requested change has been made.



## Response Document

- Q. Two communications were received from the Borough of Beachwood. One asked that the Borough's compost facility be described in accordance with the current block and lot system. The other was a letter from the Superintendent of Public Works noting that the mandate of additional materials to be recycled will increase the Borough's operating costs.
- A. The requested changes in block and lot designations have been made. It is hoped that in time the value of recycled materials and avoided tipping fee costs will make recycling less expensive than disposal.
- Q. The Ocean County Utilities Authority asks that the small incinerator used for grease and sludge oil be taken from the list because it was an operating unit of the sludge management facility which has been dismantled and removed.
- A. The incinerator has been removed from the list.
- Q. The Authority asks that its new "sludge (biosolids) dryer" be included in the list of facilities.
- A. The sludge dryer is not a solid waste facility and need not secure a solid waste permit. Its inclusion in the

## **Response Document**

County Solid Waste Management Plan is unnecessary and inappropriate. Sludge processing facilities are regulated under the Water Pollution Control Act (N.J.S.A. 58:10A-1 et seq.).

### **2. Letter submitted on behalf of Ocean County Landfill**

- Q. "...the Amendment states that construction and demolition materials designated as recyclables "may not be disposed at the Ocean County Landfill". This prohibition is contrary to the Order of the Court and the emergency regulations adopted by the Department of Environmental Protection which would permit the disposal of Type 13C wastes at any facility in the State."
- A. The Amendment does not disallow the landfilling of Type 13C wastes; even less does it prohibit such disposal of construction and demolition material components of Type 13C. In fact, it grandfatheres the existing cell for stumps and allows for continued disposal although stumps are now a mandatory recyclable. What is impermissible is the landfilling of County-designated recyclables whether they be components of Type 13C or of some other waste category. Preventing the landfilling of designated

## Response Document

materials such as concrete, cement blocks, brick, asphalt, etc., is consistent with the longstanding practice of prohibiting the landfilling of cans, bottles, newsprint, etc. Nothing in the November 28, 1995 Order of Judge Irenas (Atlantic Coast Demolition etc. v. Board of Chosen Freeholders of Atlantic County et al.) or the emergency regulations adopted by the Department of Environmental Protection negates this management practice. (In fact, in a memorandum of January 24, 1996 the then Director of DEP Division of Solid and Hazardous Waste provides illustrative information to serve as part of the response document written in connection with the promulgation of the emergency regulations. In examples 3 and 5, the Department points out explicitly that "The recyclable components are not subject to the new regulations or the current waste flow rules." The sentence refers to recyclable components of Type 13C wastes.)

Neither the orders of the Court nor the Department's emergency regulations alter the County's right to designate components of 13C waste, or other waste categories, as recyclables to be separated for special treatment.

## Response Document

Q. Properties acquired by OCLF noted in the Amendment were leased and not purchased.

A. The correction has been made.

Q. It is hoped that the County's desire to preserve OCLF for use by its residents should not be interpreted as imposing such a limitation.

A. The limitation has not been imposed; it is clearly the Freeholders policy preference. The Freeholders want to do all that is lawful to preserve the capacity of OCLF to meet the County's waste disposal needs in the future.