



State of New Jersey

DEPARTMENT OF ENVIRONMENTAL PROTECTION

Division of Solid & Hazardous Waste

401 E. State Street

PO Box 420, Mail Code 401-02C

Trenton, New Jersey 08625

Tel: (609) 984-4250

Fax: (609) 777-1951

www.state.nj.us/dep/dshw

PHILIP D. MURPHY
Governor

SHEILA Y. OLIVER
Lt. Governor

CATHERINE R. McCABE
Commissioner

AUG 18 2020

Anthony M. Agliata, Planning Director
Ocean County Department of Solid Waste Management
129 Hooper Avenue
P.O. Box 2191
Toms River, NJ 08754-2191

Dear Mr. Agliata,

The Department of Environmental Protection's Division of Solid and Hazardous Waste is in receipt of a request for administrative action to the Ocean County District Solid Waste Management Plan (County Plan) dated July 27, 2020. This amendment to the County Plan proposes County Plan inclusion of the modification to the daily incoming capacity of Rubbercycle, LLC located on Block 1609, Lot 2802 at 1985 Rutgers University Blvd. in the Township of Lakewood from 84 tons per day (tpd) of scrap tires to 150 tpd of scrap tires.

Pursuant to N.J.A.C. 7:26-6.11(b)14, the expansion of a recycling facility can be accomplished via an administrative action. Therefore, this request for County Plan inclusion of the daily capacity increase to 150 tpd of scrap tires at the Rubbercycle, LLC Recycling Center is hereby approved as an administrative action pursuant to N.J.A.C. 7:26-6.11(f).

If you have any questions relative to this matter, please contact Joanne McClendon of my staff at (609) 292-2125 or by e-mail at joanne.mcclendon@dep.nj.gov.

Sincerely,

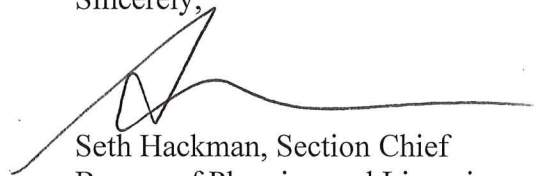

Seth Hackman, Section Chief
Bureau of Planning and Licensing

ANTHONY M. AGLIATA, P.P., L.L.A.
DIRECTOR
JOHN C. SAHRADNIK
COUNSEL



GARY QUINN
FREEHOLDER - LIAISON

SOLID WASTE ADVISORY COUNCIL
ANGELA KACSUR, CHAIRPERSON
DAVID MOST, VICE CHAIRPERSON

**OCEAN COUNTY
DEPARTMENT OF SOLID WASTE MANAGEMENT**

129 Hooper Avenue
P.O. Box 2191
Toms River, New Jersey 08754-2191
Telephone (732) 506-5047
FAX (732) 244-8396

January 31, 2020

Michael Trocchia, Environmental Engineer
New Jersey Department of Environmental Protection
Bureau of Recycling and Hazardous Waste Management
401 East State Street
P.O. Box 420
Trenton, NJ 08625-0420

Dear Mr. Trocchia:

The County has received a request from Rubbercycle, LLC, to increase their allowable daily incoming tire capacity, from 84 Tons Per Day (TPD) to 150 TPD. As part of this action, storage areas "E" and "F" at the facility will now be recognized as part of the site plan and Rubbercycle agrees that only half (25) of the site's 50 total trailers shall be filled with tires at any given time.

The County includes Rubbercycle's increased storage capacity, with the above conditions, into the Ocean County District Solid Waste Management Plan as an Administrative Action, pursuant to N.J.A.C. 7:26-6:11.

Should you have any questions, please do not hesitate to contact me.

Very truly yours,

Anthony M. Agliata
Director, Solid Waste Management

AMA:sm
Attachments

cc: Dan Mulligan, Ocean County Fire Marshall

Recycled Paper



SPECIAL ASSISTANCE/ACCOMMODATIONS available, please call (732) 506-5047

SEA

RUBBERECYCLE™

December 12, 2019

Ocean County
Solid Waste Management
Anthony M. Agliata, Planning Director
129 Hooper Avenue,
Toms River, N.J. 08754
Phone: (732) 506-5047
Fax: (732) 244-8396

OCEAN COUNTY
PLANNING DEPT. &
SOLID WASTE MGT.
2019 DEC 13 P 1:05

Dear Mr. Agliata

Re: Email from Mr. McLaughlin, dated Dec 3rd.

Rubbercycle has been in business since 1997, recycling scrap tires into Playground Rubber Mulch Surfacing. Rubbercycle has slowly grown to be at the forefront in tire recycling industry by pioneering, introducing, marketing and selling Rubber Mulch into the playground surfacing market.

Our sales have continued a steady annual growth and as such we have successfully expanded our operation and naturally have increased our Tire Recycling and our storage capacities.

Our NJ DEP Permit is expired and we are applying for a renewal, therefore we are requesting an administrative action to increase our tonnage to 150 Tons per day.

Please see enclosed our Tax Map.

Sincerely,

Robert Bestetner

Rubbercycle LLC

DEP permit Number 1514001415

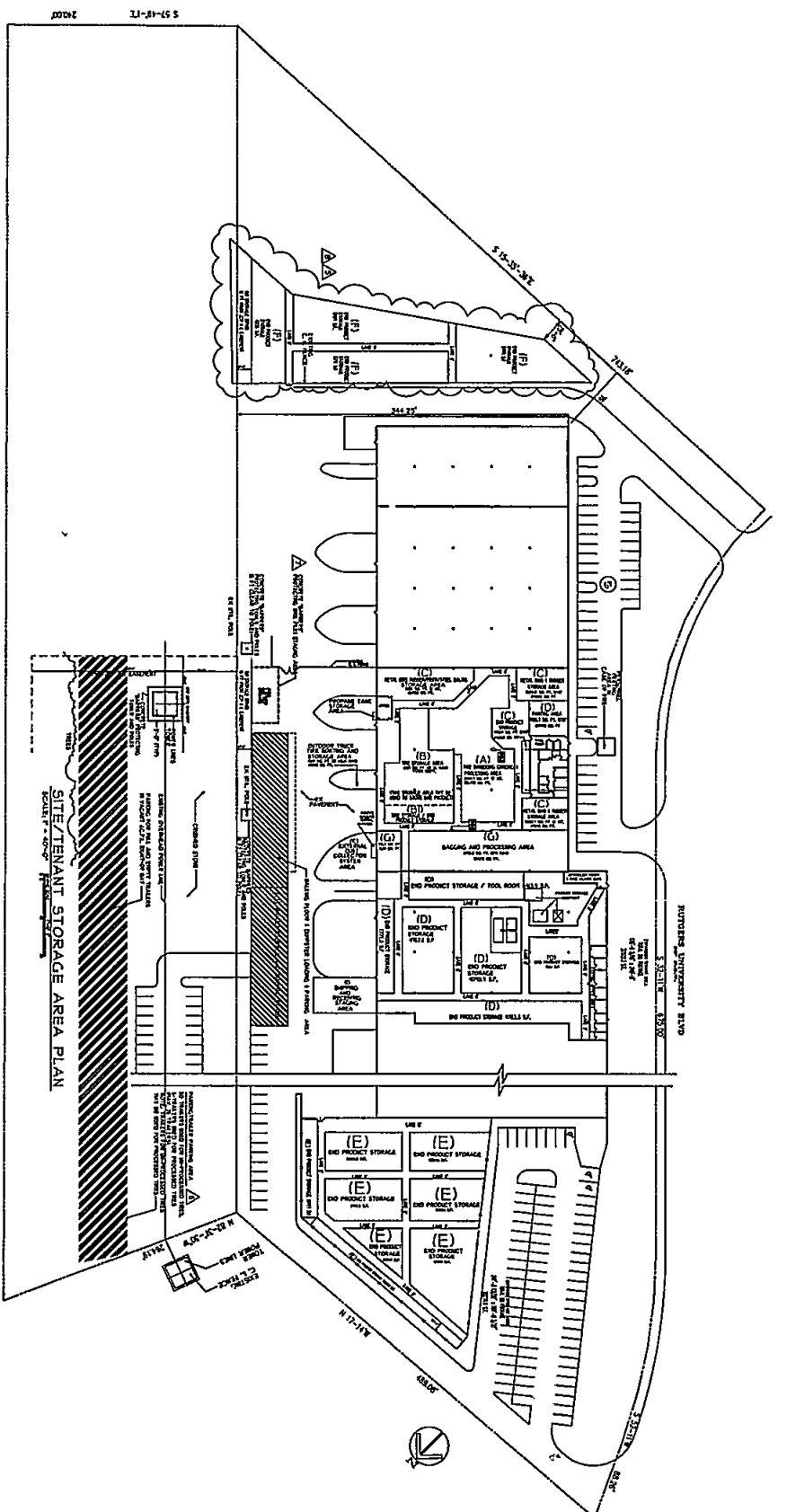

AREA	USE OF AREA	NO. CITY OF TRIES
AREA V'	PROCESSING EQUIPMENT	1/4
AREA V''	PROCESSING TRAYS	1/4
AREA V'''	PROCESSING TRAYS - REAR	1/4
AREA V''''	PROCESSING TRAYS - 180 DEGREE NORTH	1/4
AREA V'''''	PROCESSING TRAYS - 180 DEGREE SOUTH	1/4
AREA V''''''	PROCESSING TRAYS - 180 DEGREE WEST	1/4
AREA V'''''''	PROCESSING TRAYS - 180 DEGREE EAST	1/4
TOTAL		3/4

TOTAL QUANTITY AREA V' NORTH = 1300 SQUARE FEET
 TOTAL QUANTITY AREA V' SOUTH = 1300 SQUARE FEET

APPROVED BY : _____
 SIGNATURE OF OCEAN COUNTY FIRE MARSHAL DANIEL P. REILLY

